

**MUSEUM OF MEMORIES
A SPACE TO KEEP SILENT LOVE
Participant ID: ASDA26-50332**

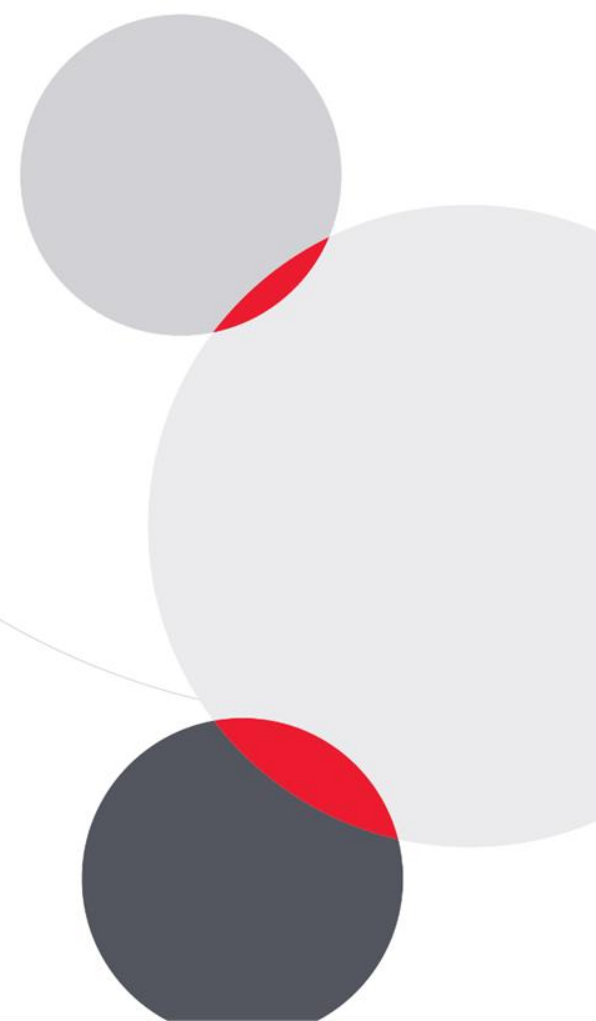

Design Concept Summary

- The design aims to maximize the bathroom's square footage to accommodate multiple users simultaneously. Every detail is meticulously crafted to align with **ergonomic standards** and the specific habits of each generation within the family.
- By integrating devices with **automatic safety shut-off** features, the design ensures a secure user experience.
- Focuses on subtle refinements based on the family's daily routines, addressing common inconveniences of a shared bathroom to ultimately elevate the overall user experience.

Everyday acts of love are preserved within the objects we know and cherish

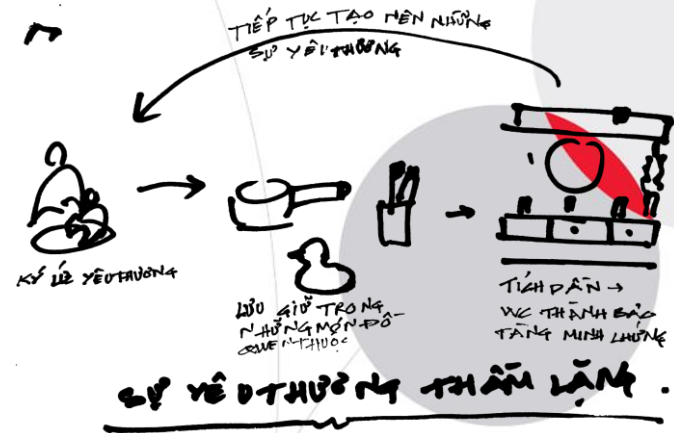
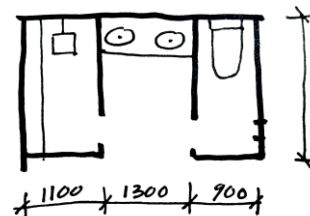
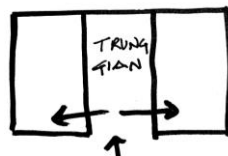
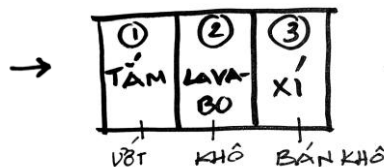

Design: Floor Plan and Elevations

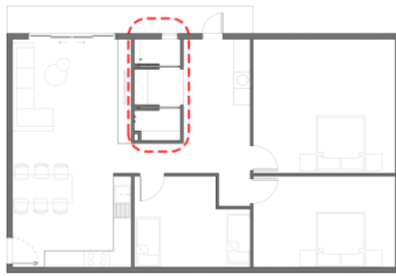

Apartment floor plan



Access point

The bathroom is divided into three functional zones.

- The vanity area features double sinks, allowing multiple family members to use the space simultaneously without having to wait
- Wall niches and technical recesses are repurposed into neat storage spaces
- A centralized exhaust fan is integrated with a ducting system to extract humid air from each zone and vent it outside. This system also features a heating function to maintain a warm environment during the winter.

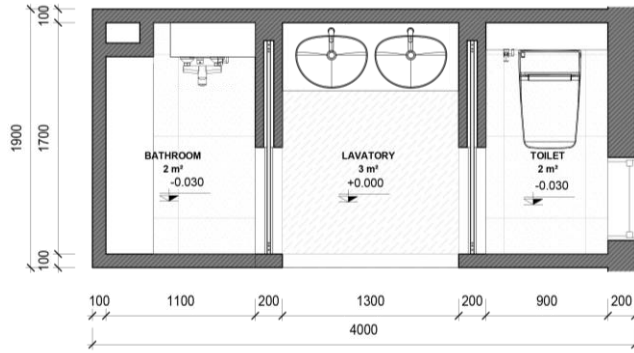

FLOOR PLAN

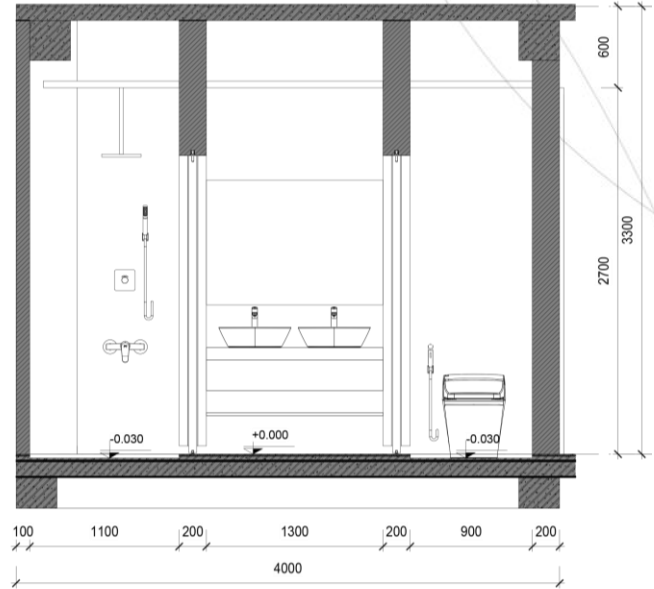

ELEVATION

**Total Bathroom Area
in sqm (including wall
& columns)**

7,02 m2

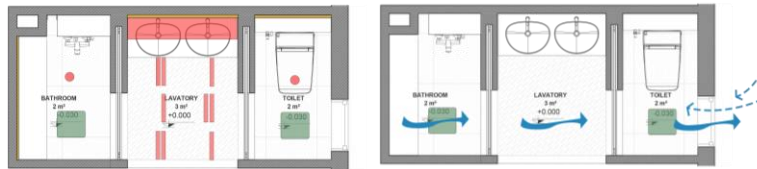

Design Visuals: Overview

The space is tucked away from the main common areas to ensure privacy, yet remains easy to locate and well-ventilated



Design
Visuals:
Full
Bathroom



Design Visuals: Shower Area

- The bathroom features a clean white color palette paired with anti-slip matte floor tiles, while warm lighting creates a relaxing and healing atmosphere.
- The fixtures are selected for their simplicity and intuitive design, making them easily recognizable for both the elderly and children, ensuring convenience and efficiency in daily use



as:da
American Standard
Design Award 2026

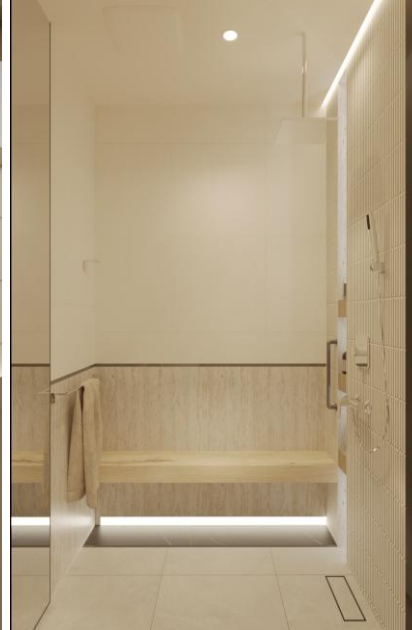

Design Visuals: Toilet Area

- The toilet is equipped with a smart bidet seat featuring an auto-flush function—specifically addressing the forgetfulness often experienced by the elderly—alongside a seat-warming feature for maximum comfort.
- A traditional handheld bidet sprayer is also retained as a backup during power outages. Behind the toilet, a decorative wall panel doubles as a concealed cabinet, providing a neat storage solution for toiletries and cleaning supplies.

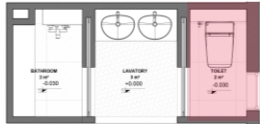

as:da
American Standard
Design Award 2026

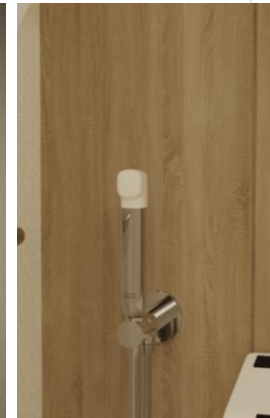
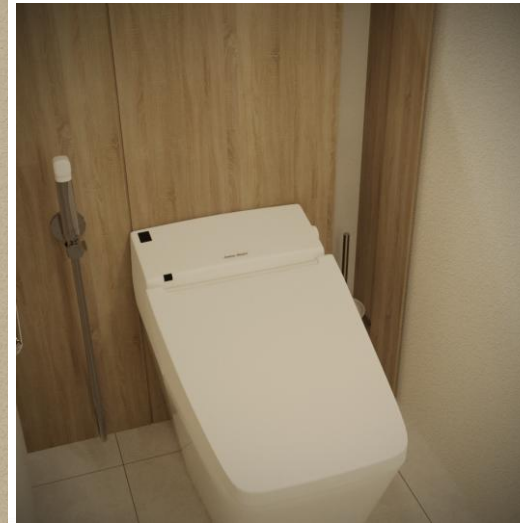

SLIDE 7

Design Visuals: Basin Area

- Double sinks are utilized to increase usage efficiency, featuring easy-to-clean white porcelain enamel for a pristine look.
- The vanity is designed with additional drawers and open shelving to organize miscellaneous items such as skincare, dry towels, hair dyes, and essential oils.
- Furthermore, the stylized ceiling adds a touch of liveliness to the space, breaking the monotony while maintaining a rustic, tranquil feel without being visually overwhelming.

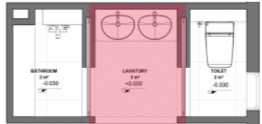

as:da
American Standard
Design Award 2026



Design Visuals: Optional Images/ Information

Every nook and cranny within the bathroom is thoughtfully utilized to accommodate the essential items that naturally accumulate from the family's daily routines



Design Visuals: Optional Images/ Information

It is the simple acts of caring for one another and the shared moments of daily life that create our most beautiful memories



Specifications: Colors, Materials and Finishes



Grey cloud-veined marble with a smooth finish.



Fabric



Wood



Light grey stone-look tiles with a matte, non-slip finish.



Natural wood



Tile block

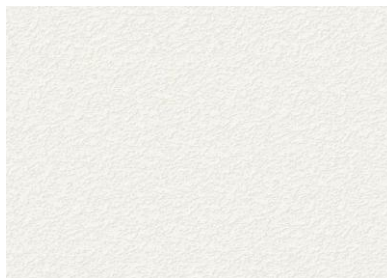



White painted wall





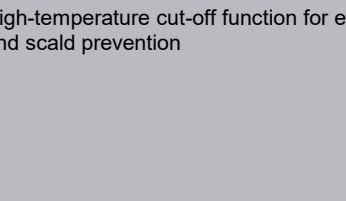

Light brown vein-cut marble with a matte, textured finish



American Standard Products Specified

	Product Name	Product Image	Reason for Selection
1	Shower Mixer FFAS0712-701500BF0		Water and energy-efficient fixtures with smooth handle operation. Features hot/cold mixing and an anti-scald surface for enhanced safety.
2	Đầu sen phun mưa vuông_FFASS038		Polished chrome finish for a brilliant shine, high durability, and a pristine look.
3	Concealed Thermostatic Mixer with Trim_FFAS0930-000500BC0		High-temperature cut-off function for enhanced user safety and scald prevention
4	DuoSTiX™ Hand Shower (Chrome/Matte Black) with hose and hanger_FFASS508-000440BF0		Multi-spray function for efficient rinsing. Detachable head for pressurized cleaning. Anti-twist hose for enhanced durability and convenience.

American Standard Products Specified

	Product Name	Product Image	Reason for Selection
5	Acacia Evolution Shower Toilet 305mm_ CEAS5006-0000424C0		Dual-flush system for water efficiency. Smart bidet with 5 cleaning levels and feminine wash. Integrated seat heater for winter comfort. Auto-flush feature specifically tailored for elderly-friendly accessibility.
6	DuoSTiX™ Hygiene Spray (Chrome/ Glossy White) _FFASTS28-000440BT0		Includes a manual backup system to remain fully operational during power outages.
7	Acacia Evolution Toilet Brush_ FFAS1386-908500BF0		
8	Acacia Evolution Towel Bar_ FFAS1393-908500BF0		Square-profile towel bar for enhanced grip and slip resistance.

American Standard Products Specified

	Product Name	Product Image	Reason for Selection
9	Neo Modern Vessel Wash Basin _CCASF633-0000410F0		Softly curved forms for a gentle aesthetic and enhanced user safety
10	Neo Modern Extended Mixer With Stop Valve & Pop Up _FFAS0703-101500BF0		Transitional-style fixtures paired with an oval washbasin for a timeless yet contemporary look.
11	Thanh đầu nối sen_FFAS9908		

Appendix

Design Story – Limit to 150 words per answer.

- What is the inspiration for your design?

The inspiration for this design stems from observing how family members use the bathroom, taking into account their inconveniences and recurring issues. Furthermore, since bathroom objects hold significant meaning for each user, the goal was to resolve existing problems without completely stripping away the sense of familiarity.

- How does the design fulfill the need of the target users?

The design optimizes usable space and heights tailored to all family members, prioritizing convenience and simplicity over excessive, confusing features. Instead of creating separate spaces for each individual, the design consolidates functions into a shared, versatile area that fulfills everyone's essential needs.

- How does the design fulfill the design challenge?

The primary challenge of this design lies in the limited square footage versus a high number of users—a common issue for families living in apartments. Each area is designed based on minimum ergonomic standards, ensuring that users can move and function naturally without obstruction.

- How does the choice of products contribute to the purpose of the design?

The primary goal of this design is to ensure a seamless and comfortable experience for users of all ages, with safety as the top priority. Accordingly, all selected fixtures are equipped with safety features, such as automatic circuit breakers and power shut-offs, to mitigate potential hazards.



Let your ideas transform
everyday routines into
meaningful experiences!

American Standard

