



Inspiring Everyday Living

Design Entry Template





Design Entry Template Guidelines

You will find the following slides in this Submission Template with specific titles and requirements for your submission as indicated below. Total number of your submission should not exceed 15 slides, beginning with (Slide 1: Project Name) and ends with (Slide 15: Qualification Checklist).

SLIDE 1:
Project Name

Input a concept title that reflects your idea.

SLIDE 2:
Design Concept

Describe your concept in a nutshell,
keep it within 150 words.

SLIDE 3:
Design: Floorplan and Elevations

Organize your drawings to tell your story.

SLIDES 4-10:
Design: Visuals

Present your concept with your renderings.

- Slide 4: Overview
- Slide 5: Full Bathroom
- Slide 6: Shower Area
- Slide 7: Toilet Area
- Slide 8: Basin Area
- Slide 9 & 10: Optional Images/Information

SLIDE 11-12:
Specifications: Colors, Materials and Finishes

SLIDE 13:
American Standard Products Specified
List down the products that are used in your design.

SLIDE 14:
Appendix
Elaborate your design story.

SLIDE 15:
Qualification Checklist
Before submission, review this list.

**A space for all ages in the family
Create exciting relationships and
inspiration together**
Participant ID:ASDA26-10582

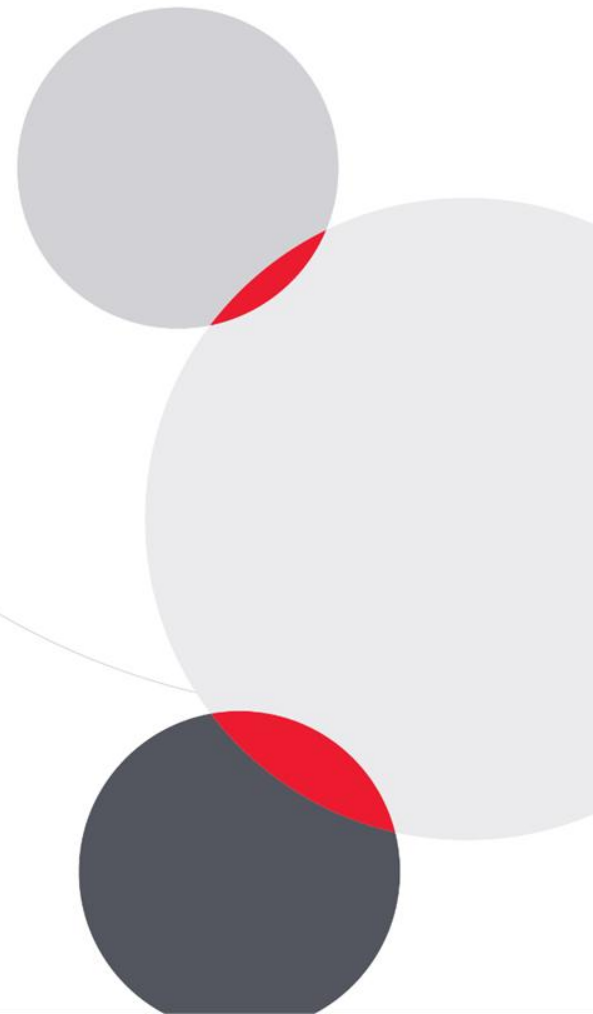

Design Concept Summary

The design is inspired by my own life story of a large family home that is also spacious enough for all ages. I wanted to challenge myself to create a room that is versatile for various users, incorporating the modern era and the social media focus of young people, while also creating a space that inspires daily life for everyone in the family and connects with nature, providing a relaxing space to sit and unwind.

Design: Floor Plan and Elevations

The dry and wet zones are clearly separated. The area beside the sink can also be used as a seating area or waiting area. Windows have been installed to let in natural light and provide good ventilation through two windows.

This area can be used by the whole family because it's divided into zones with doors and seating areas, creating a feeling of shared daily life.

**Total Bathroom Area
in sqm (including wall
& columns)**

Enter here

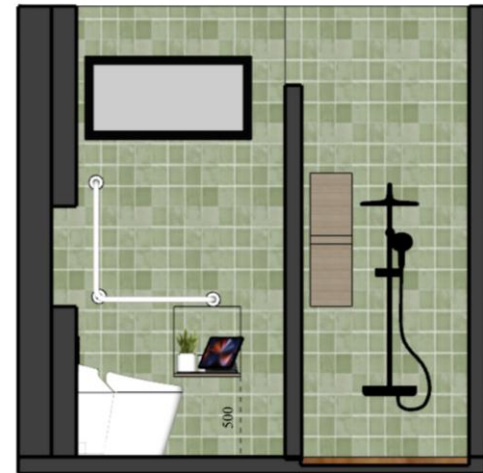
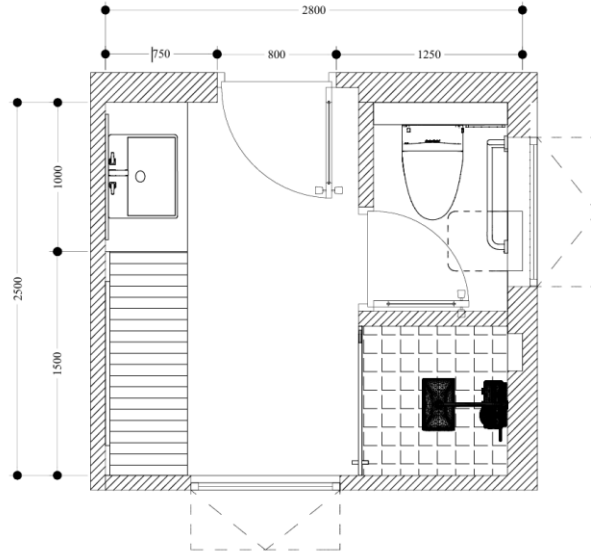

Design
Visuals:
Overview



Design
Visuals:
Full
Bathroom



Design Visuals: Shower Area

The wet zone is a shower area with a multi-functional shower head, temperature control, and a shelf for shower accessories. The floor in this zone is sloped at a 1-degree angle towards the drain hole

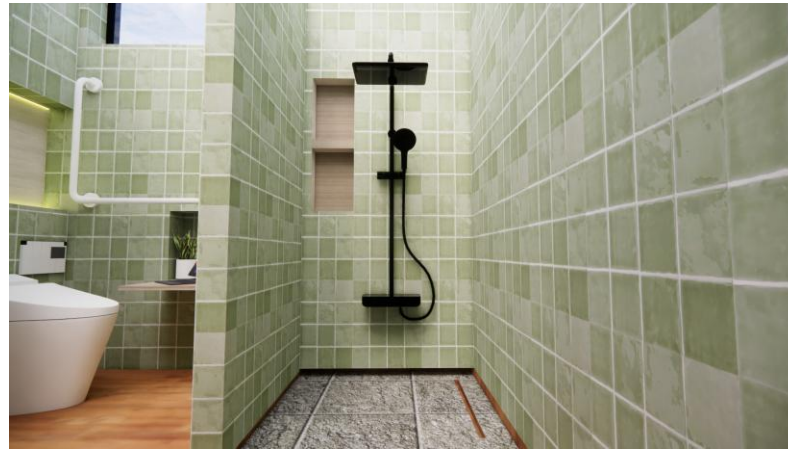

Design Visuals: Toilet Area

The bathroom will utilize a state-of-the-art automated system. Modernly designed, it will include spaces for mobile phones and iPads, creating a perfect creative space for the social media-driven era. We've also considered the needs of the elderly, so we've installed assistive devices on the sides.

Don't worry about spending too long in the bathroom because it's designed with zones that allow you to shower, wash your hands, or wipe down the toilet at the same time.



Design Visuals: Basin Area

The sink area features a sleek, wall-mounted, floating countertop sink for a sophisticated and uncluttered look. The area beneath the sink primarily serves as storage for items such as towels, and there's also a stool to elevate the sink for children to use while washing their hands. The adjacent zone offers versatile functionality, usable as a play area, shelving, or even an ironing area.



Design Visuals: Optional Images/ Information

This wall-mounted phone holder is foldable and also has a hidden tissue holder.



Design Visuals: Optional Images/ Information

It's a seating area that can be unfolded to become a table for placing items or ironing clothes.

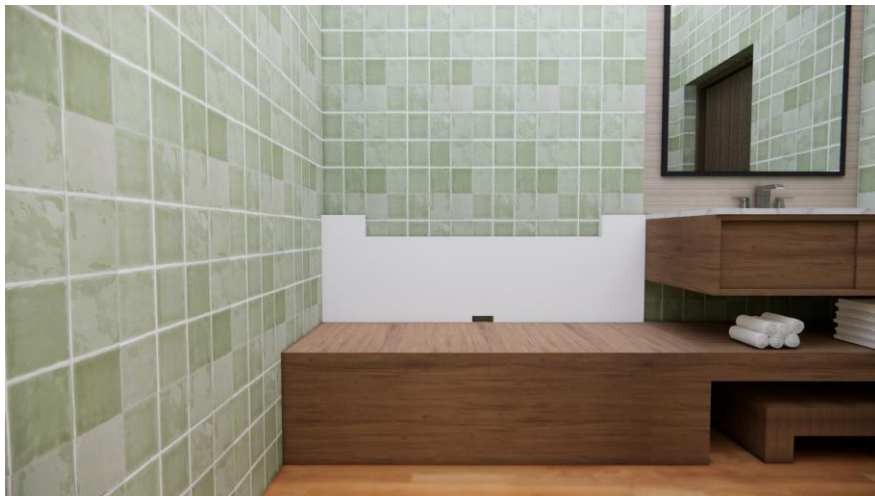

Specifications: Colors, Materials and Finishes

We chose materials in natural tones because they give a feeling of being close to nature and relaxing. For me, being with nature helps me be creative and design a space that inspires exploration at any time.

Although the basket isn't made of natural materials, I chose green to represent leaves and nature



Wall-mounted silo.



A gentle routine for
counter – skinned users



Nature wood for shelf

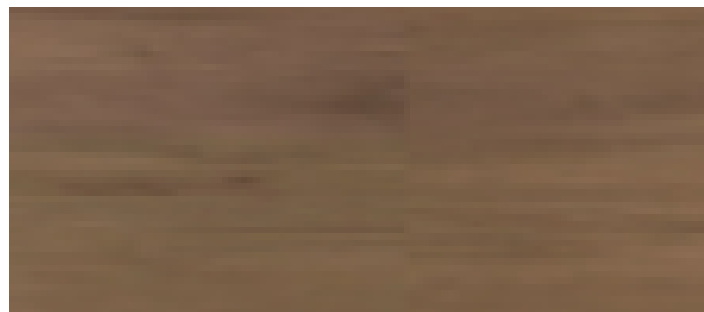

Nature wood for counter
sink



Nature wood for door







American Standard Products Specified

Use the space on the right to:

1. Indicate the list of American Standard products used with the template on the right.

1. State the reason for selecting each product and why you believe it addresses the needs of travelers in hospitality bathroom spaces.

You may use more than one slide if required.

Z	Product Name	Product Image	Reason for Selection
1	Aerozen G2 Shower Toilet		Therefore, cleaning this toilet with its automatic system is versatile and suitable for modern bathrooms.
2	L Nylon grab bar(Left)		Paying attention to the needs of the elderly, we designed restrooms that are accessible and convenient for everyone of all ages.
3	Acacia SupaSleek Vessel 600mm 3-Hole 8"		Countertop sinks offer a clean and modern look, and feature three water settings including hot and cold water
4	EasySET Exposed Auto Temperature Shower_Polished Hard Graphite		This shower head features a modern, stylish color scheme and offers versatile functionality. It boasts an efficient and easy-to-use temperature control system suitable for all ages.
5	Concept Square Towel Rack_Polished Hard Graphite		A hanging towel rack in a color scheme that matches the shower.
6	Signature 3-Hole Basin Mixer_Polished Hard Graphite		Fill the dispenser with water through the three holes and easily adjust the hot and cold-water levels. It's convenient and beneficial for the health of the elderly or patients who need a suitable temperature for their face and hands.

Appendix

Design Story – Limit to 150 words per answer.

- What is the inspiration for your design?

I was inspired by my own family, as our home is a multi-generational hub where the bathroom is adequately equipped for everyone. Therefore, I wanted to design this project based on my own feelings and real-world usage.

- How does the design fulfill the need of the target users?

We designed this bathroom to be usable by people of all ages and accessible at any one time, as it's divided into zones, eliminating the need to wait and creating a more communal feeling. It also includes a seating area, a creative space, and windows to allow natural light and ventilation.

- How does the design fulfill the design challenge?

The challenge was to design a bathroom that could be used in multiple ways while still maintaining a sense of daily life. So, we decided to create a space where everyone in the family, of all ages, could share their daily routines.

- How does the choice of products contribute to the purpose of the design?

We chose modern and easy-to-use sanitary ware because we focus on a simple yet modern lifestyle.