

A Home to Love A Space for Everyone Design Entry Template





Design Entry Template Guidelines

You will find the following slides in this Submission Template with specific titles and requirements for your submission as indicated below. Total number of your submission should not exceed 13 slides, beginning with (Slide 1: Project Name) and ends with (Slide 13: Appendix).

SLIDE 1:
Project Name

Input a concept title that reflects your idea.

SLIDE 2:
Design Concept

Describe your concept in a nutshell, keep it within 150 words.

SLIDE 3:
Design: Floorplan and Elevations

Organize your drawings to tell your story.

SLIDES 4-9:
Design: Visuals

Present your concept with your renderings.

- Slide 4: Full Bathroom
- Slide 5: Shower Area
- Slide 6: Toilet Area
- Slide 7: Basin Area
- Slide 8-9: Optional Images

SLIDE 10-11:
Specifications: Colors, Materials and Finishes

SLIDE 12:
American Standard Products Specified

List down the products that are used in your design.

SLIDE 13:
Appendix

Elaborate your design story.



Design Concept Summary

The Flexible Era

A multi-generational household is made up of various generations living together under one roof. Different group of age has its own needs. An accessible details is also the priority for the young and elderly to make them feel secure. Not to forget to add a hint of playfulness for the young ones to balance its design. A flexible space design is ideal within the limited space to save up the space and make it multi-purpose.

The aesthetic implied is inspired by the coral reef. It's a fact that a resilient coral reef has high levels of diversity which creates what's known as "functional redundancy". Correlating its diversity and flexibility creates multipurpose space design.

CONCEPT DIAGRAM:

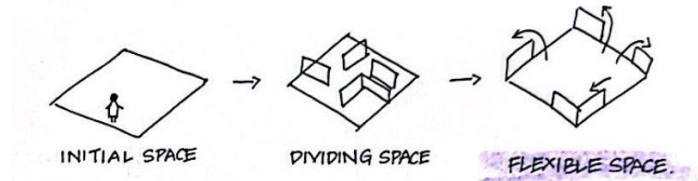

Design: Floor Plan and Elevations

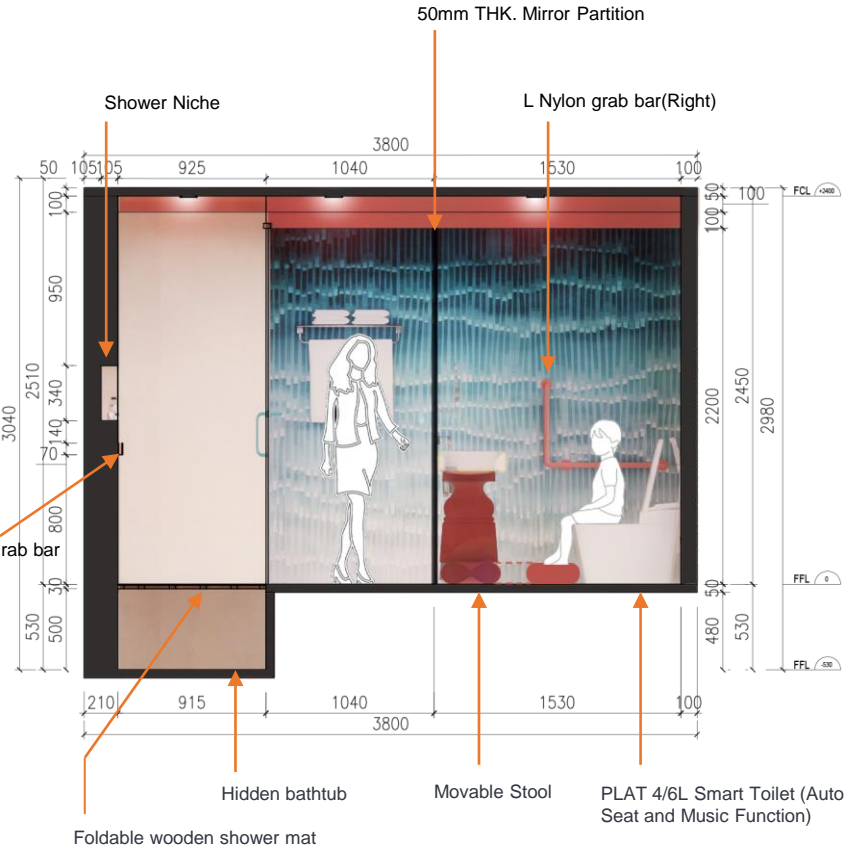
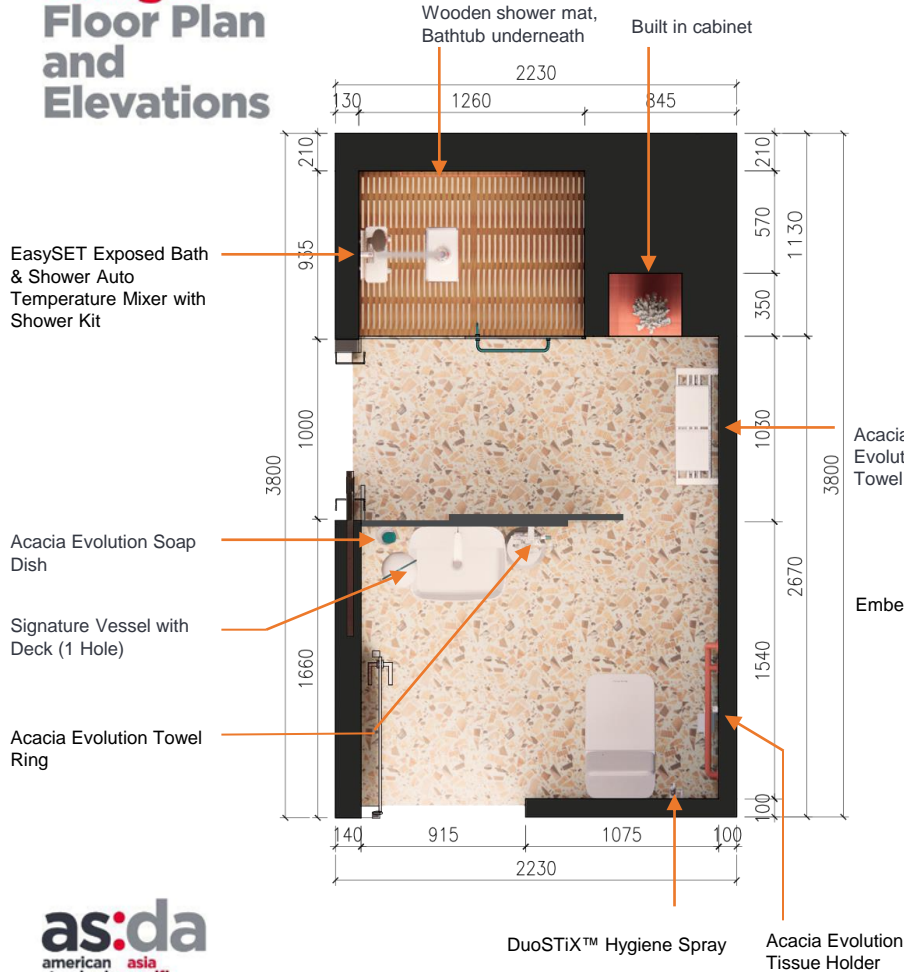

Design Visuals: Full Bathroom

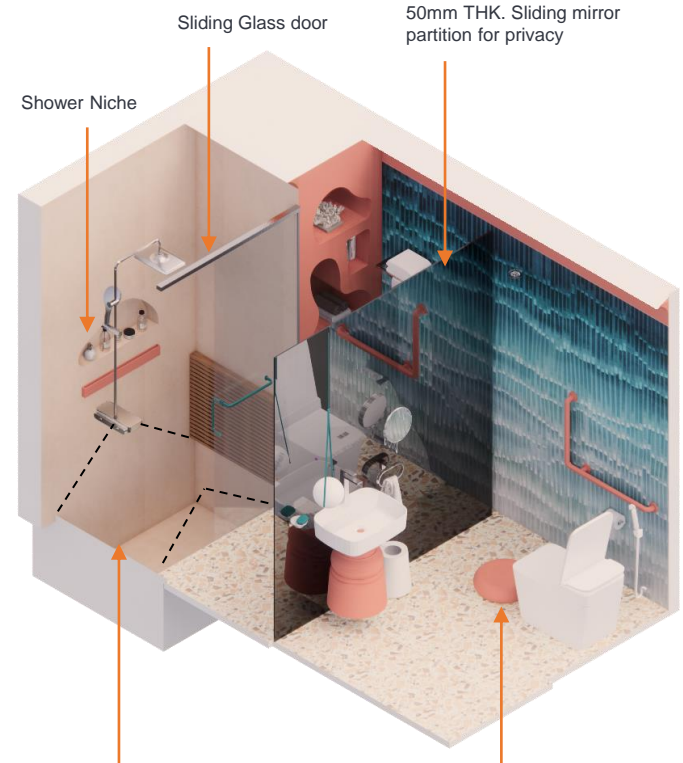
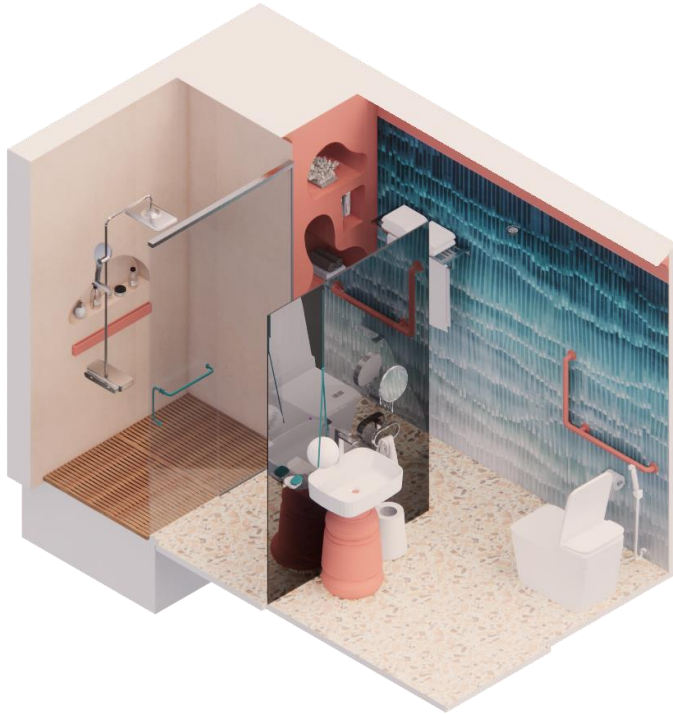

Design Visuals: Shower Area

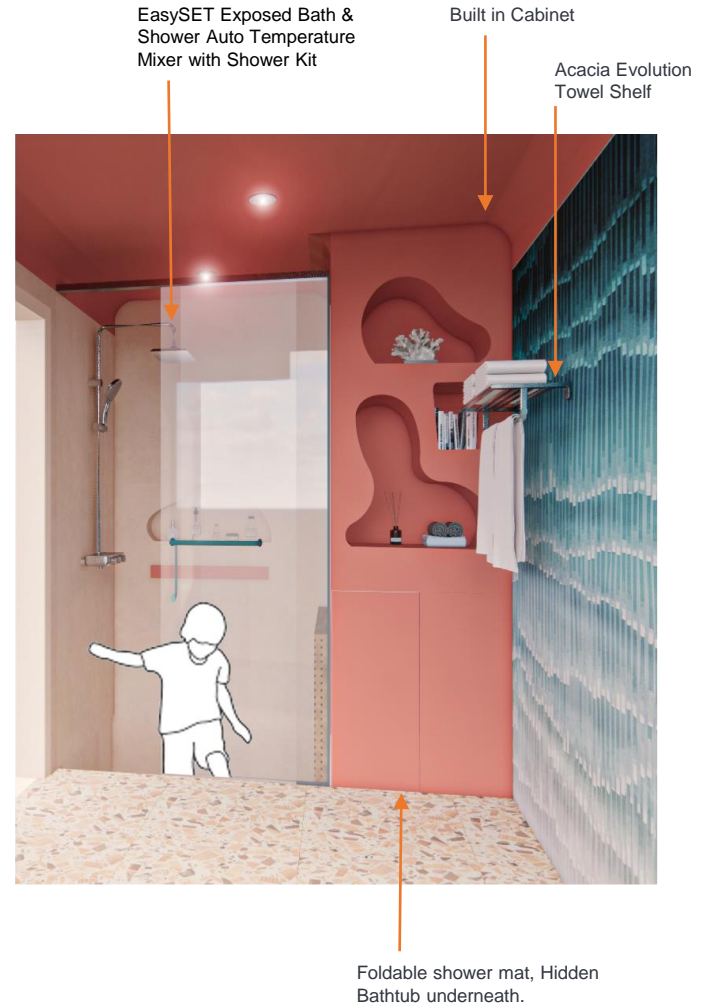

Design Visuals: Toilet Area



L Nylon grab bar(Right)



Acacia Evolution
Tissue Holder

Movable stool for
reaching the basin &
correct position to use
the toilet.

PLAT 4/6L Smart
Toilet (Auto Seat and
Music Function)

Design Visuals: Basin Area



Movable stool for reaching the basin

Acacia Evolution Towel Ring

Design Visuals: Optional Images/ Information

Entrance from the bedroom
using pocket door

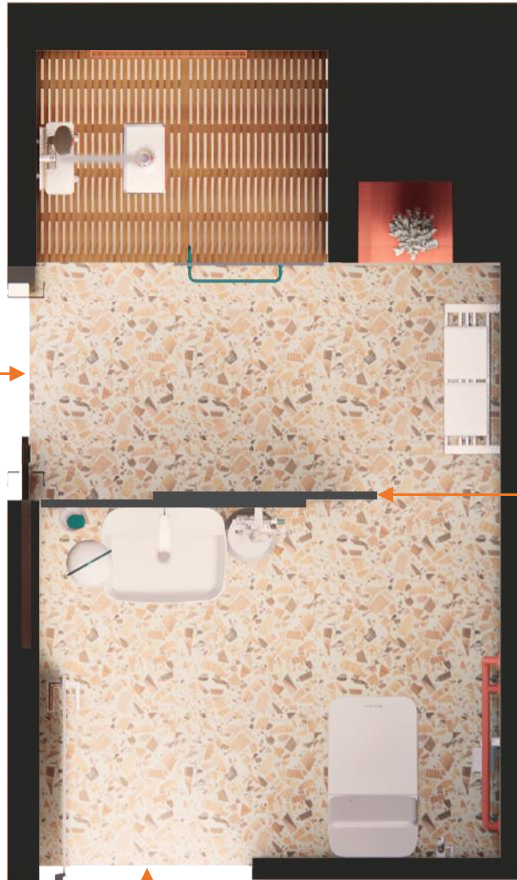

Sliding mirror
partition for privacy
in the shower area

Entrance to the powder room



Bathtub scene

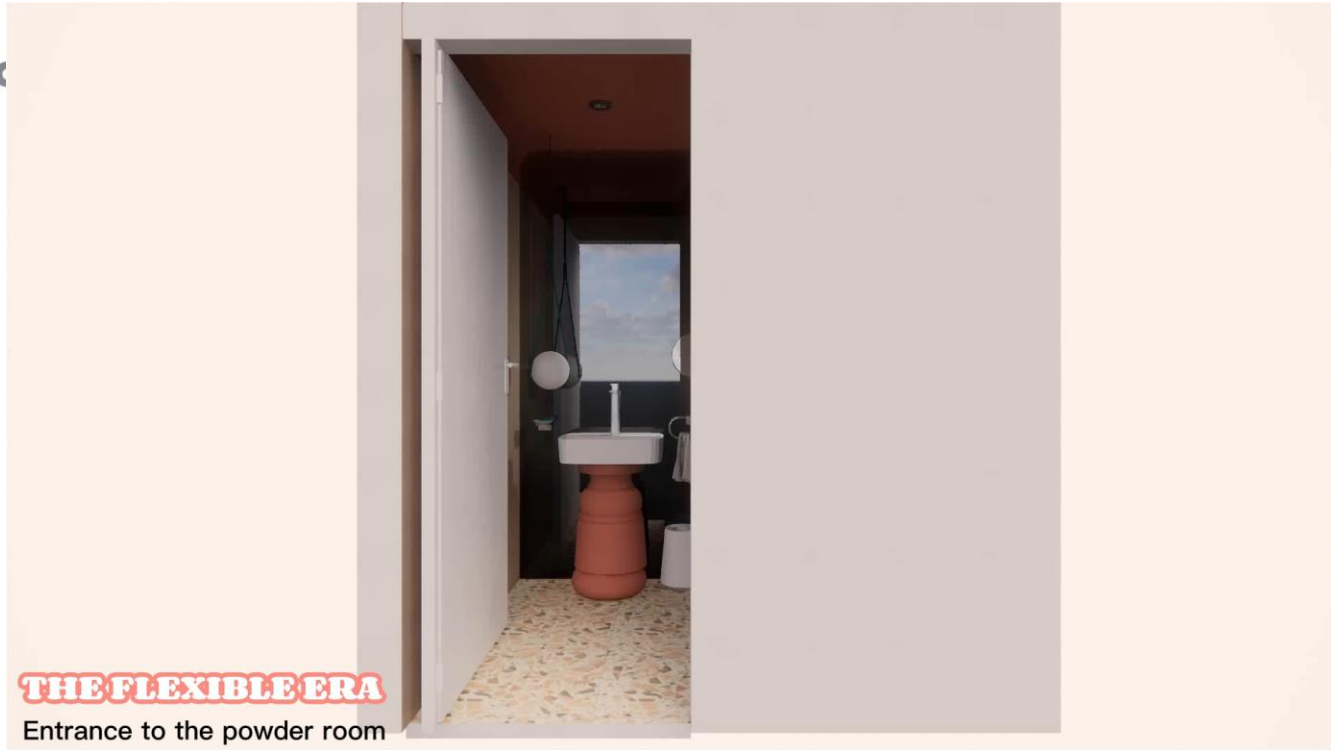

THE FLEXIBLE ERA

Entrance to the powder room

Link to the video: https://drive.google.com/file/d/1yof1GHF2A5JXYnGI8_ftZgkqSqvHFkzi/view

Specifications: Colors, Materials and Finishes

Powder room Legend

- 1. Coral Beach Dulux Paint
- 2. 50mm THK. Mirror Partition
- 3. Stainless steel
- 4. Fluvia Vinyl Wallpaper
- 5. 600mm x 600mm Matte Peach Puff Stone tile
- 6. Sustainable Timber Wood Terrazzo Flooring



Specifications: Colors, Materials and Finishes

Shower area Legend

- 1. Coral Beach Dulux Paint
- 2. Stainless steel
- 3. 600mm x 600mm Matte Peach Puff Stone tile
- 4. Glass
- 5. Christmas Spruce Dulux Paint
- 6. Anti-slip Wood Shower Mat



**American
Standard
Products
Specified**



FFASTS28-000091BT0



CL20219-6DAB



FFAS1387-908500BC0



FFAS4955-701500BC0



CCAS0618-1010410F0



FFAS9405-000040BC0



FFAS1395-908500BF0



FFAS4955-701500BC0



FFAS1390-908500BF0



FFAS1702-1015L0BC0

Appendix

Design Story – Limit to 150 words per answer.

- What is the inspiration for your design?

Incorporating flexible design to multigenerational homes can meet the needs of different generations living together while simultaneously aiding independence and accessibility, with spaces that adapt and evolve as families grow and get older. Designing a bathroom space for various generations to fill their own needs is the highlight of why flexibility is chosen. A flexible space design is ideal within the limited space to save up the limited space and make it multi-purpose.

- How does the design fulfill the need of the target users?

By having the limited space, it is important to be as flexible as possible. To create a fun environment for the young ones, I have decided to create a hidden bathtub underneath the shower area, just by flipping the 2 anti slip wooden shower mat. By having the sliding mirror partition, it could separate the shower area to be more private, incase the toilet and basin is used by the guest as the powder room. Additionally, by using mirror for the partition, it could also make the space be more spacious. Customizing a movable stool under the basin so that the kids could reach the basin, and as a footrest. It's a fact too that stepping on a stool/footrest while having a number 2 is healthier and a better position.

- How does the design fulfill the design challenge?

The aesthetic implied is inspired by the coral reef. It's a fact that a resilient coral reef has high levels of diversity which creates what's known as "functional redundancy". Correlating its diversity and flexibility creates multipurpose space design. Where the right side of the wall is a gradient blue wallpaper depicting the deep ocean. The shower area mostly use peachy toned stone tile to have a hint of the sands underneath the sea. The built in cabinets and the ceiling is a solid coral color to imply the coral reef feeling. The built in cabinets has this different organic shapes design to indicate the abstractness of the coral. Lastly, I used a sustainable timber terrazzo for the flooring.

- How does the choice of products contribute to the purpose of the design?

By using the Smart Toilet (Auto Seat and Music Function) it creates an excitement and pleasing pleasure to all the generations by having the unique feature, adapting on the flexibility of the modern culture. Its is very important to put some grab bar for adding the elderly's security and confidence in the toilet area by reducing the risk of falling. The other products too give some soothe feeling since it blends with the aesthetic and make the space more uncluttered.

as:da

american
standard
design
award

asia
pacific
2023

**Your idea can
shape how we
create homes
to love**

*American
Standard*

