

as:da

american
standard
design
award

asia
pacific
2023

A Home to Love A Space for Everyone

ASDA23-60031

SLIDE 1



*American
Standard*



Design Concept Summary

Simple Classic

Toilet is important to us as we use it everyday. However, it could be troublesome for wheelchair users or others like kids. The need of cleaning the toilet and some hidden hassle. In my design, I would like to give not just ease of use for the target user. It includes the aesthetic of the toilet and I want them to feel more like home and warm. Some people may feel uncomfortable using public toilets due to the cleanliness or due to unfamiliarity.

Design: Floor Plan and Elevations

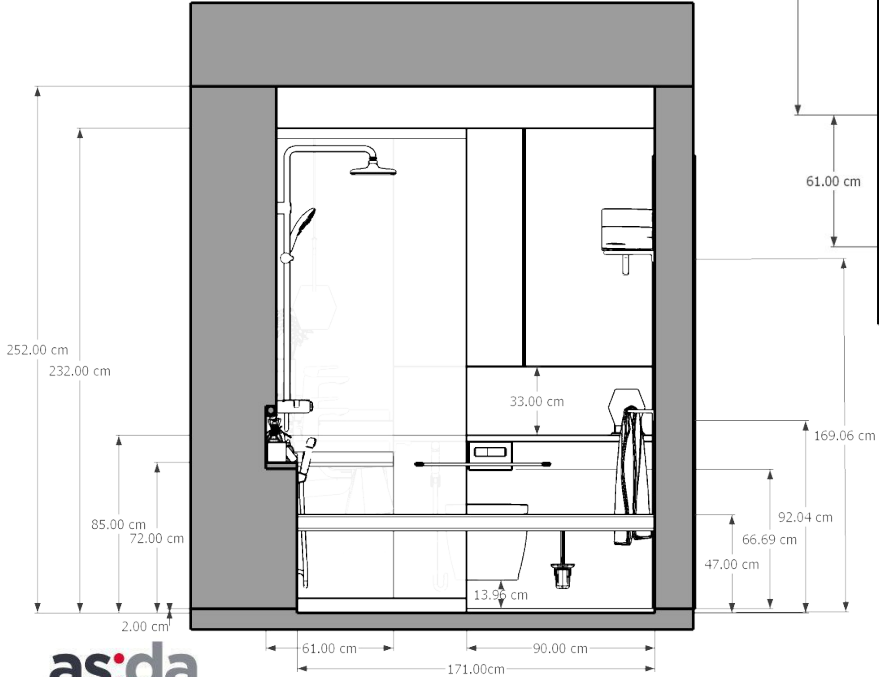

Left Elevation

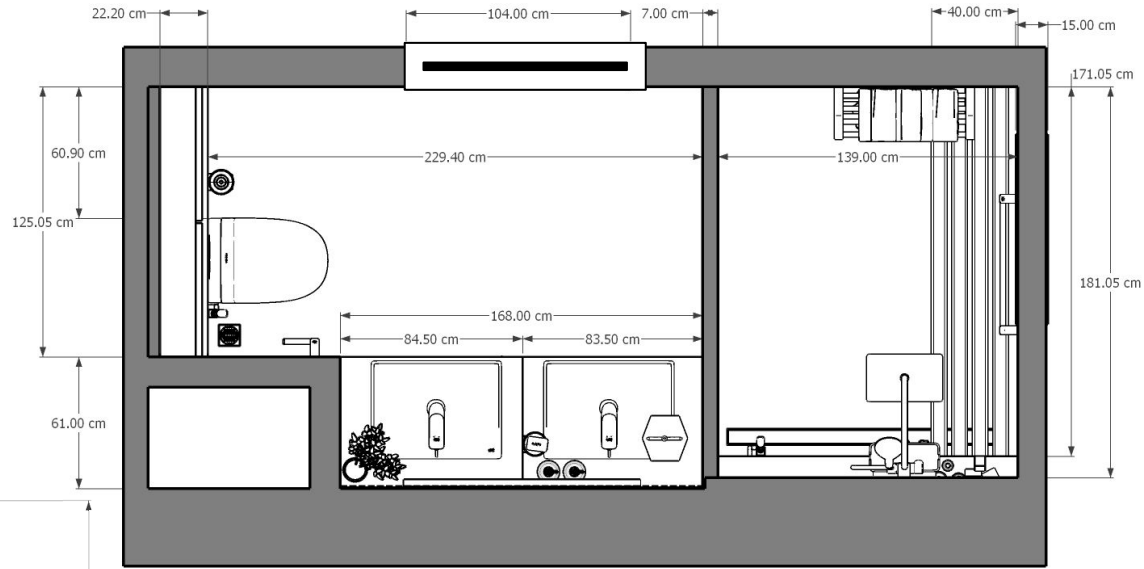

Top Elevation

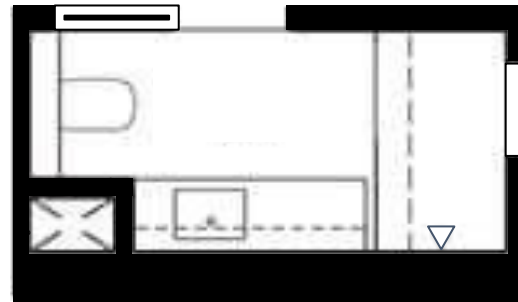

Floor Plan

**Design
Visuals:
Full
Bathroom**

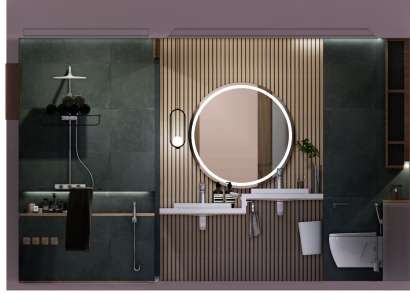

Perspective Views

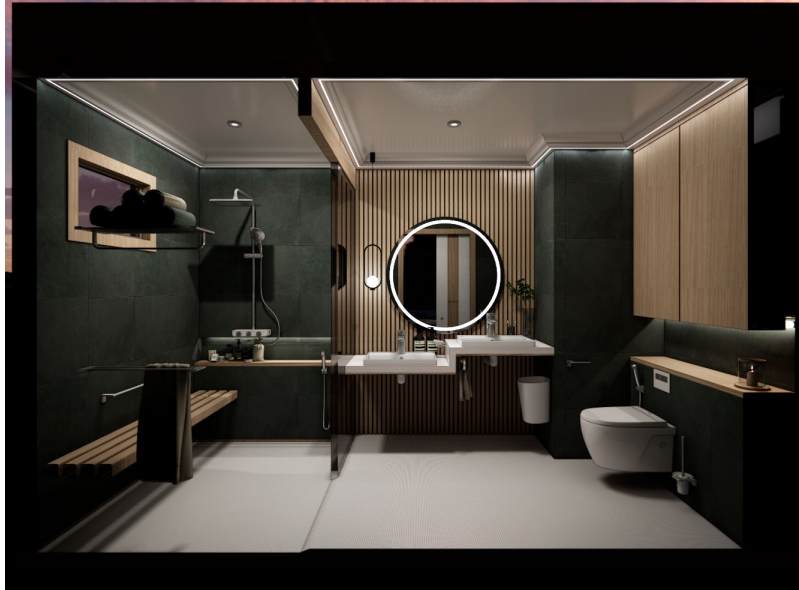

Design Visuals: Shower Area

Perspective Views of the shower area

Wooden bench is designed for user to sit while shower with the texture and colour match the overall vibe. An embedded space with about 0.2m square, provide space for soap and bottle. It's within user range of reaching out for items.

The high towel bar rack lower the possibility of getting wet, while the lower double rack is for any user who might use wheelchair and the young child to reach out easily for the towels. The single bar rack act as an rip bar for users.



Perspective Views of the toilet area

The wooden cabinet is designed for the target user to keep their daily essential items such as detergent, bottles, brush and toilet paper roll. The length and height is measured accurately for the standard size of toilet paper to be placed nicely.

The toilet bowl is hung on the wall for easy clean purposes. Together with the spray at the left side and the toilet brush at the right side. The water will flow to the drain at the corner. A small space is designed for user or their guest to place their item while using the toilet.

A wider space left at the right side of the toilet bowl, is to provide sufficient space for wheelchair user to push their wheelchair back and lift their body towards the toilet bowl.



Design Visuals: Basin Area

Perspective Views of the basin area

A high and low basins are placed for the wheelchair user and young child to use. While the higher basin are for other user, easier to reach out for the water. Especially washing of face or hair. The towel and bin is placed below to keep the basin neat. It also make use of the space below the basin. Which is left for the wheelchair user to push it closer to the tap, and wider area to make a turn or change of direction. The plant is place to enlighten the area with some greenery.



**Design
Visuals:
Optional
Images/
Information**

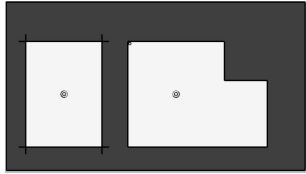

Light Plan

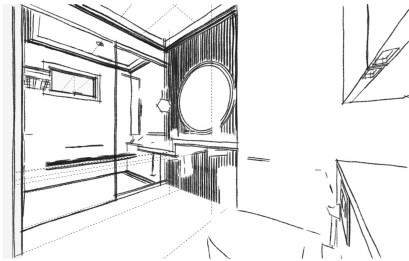

Idea Sketches

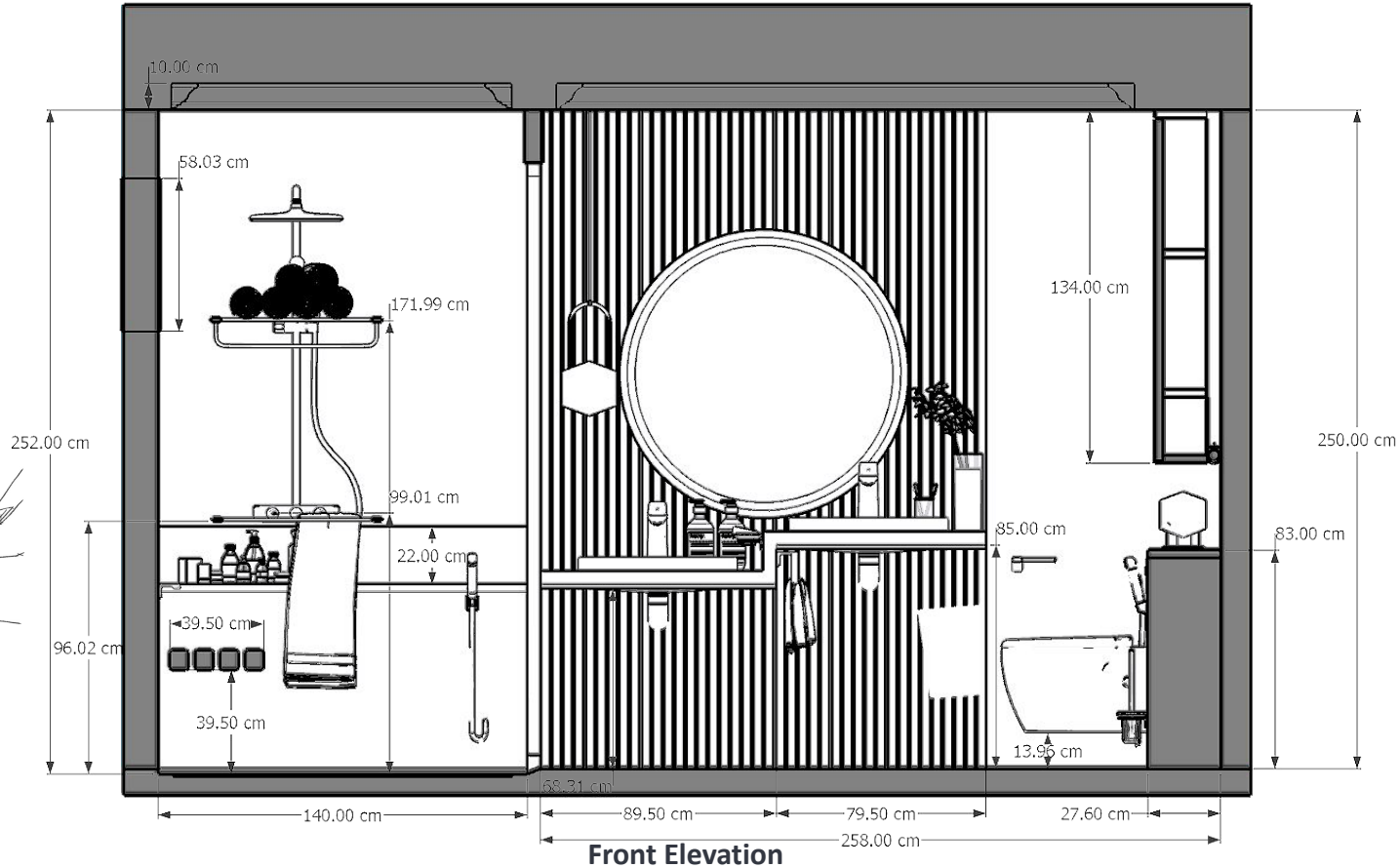

**Design
Visuals:
Optional
Images/
Information**

**Location of Used
Product in the Space**

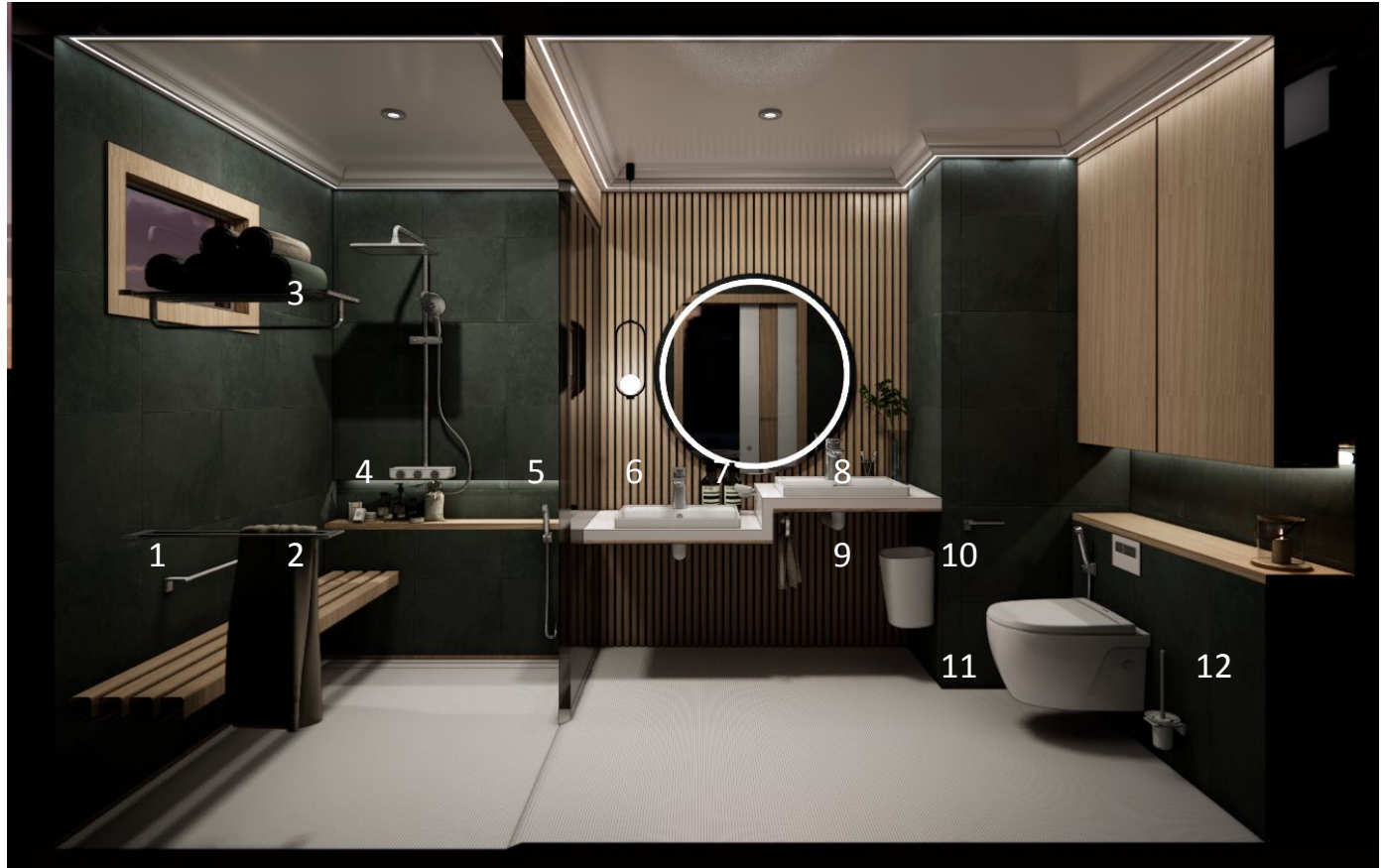

Specifications: Colors, Materials and Finishes

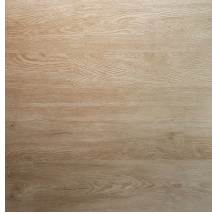

Cappuchino Amber

WOOD CULTURE_ PASTORAL 2000
Code_ WCV2111

Material_ Vinyl

<https://www.hafary.com.sg/collection/Vinyl/Wood-Culture-WCV2111-Cappuchino-Amber-2535?image=14481>

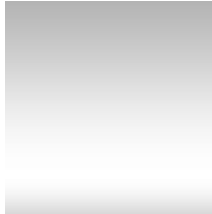

Grey Laminated Glass

Material_ PVB, SGP, EVA. etc

https://szdragonglass.com/building-glass-products/laminated-glass/?qclid=Ci0KCQIA_P6dBhD1ARisAAGi7HAYB7cw_EIEPicnZuk3zOAbNuEP9fKRP4VmYERE37B4nYkLIOfnQYaAis2EALw_wcB



Stainless Steel Plate

Material_ Steel
Finishes_ Hairline

https://www.haotisteel.com/products/stainless-steel-plate/304-316l-cold-and-hot-rolled-stainless-steel-plate-2b-ha-surf-ace-drawing-stainless-steel-plate-coil-customization.html?qclid=Ci0KCQIA_P6dBhD1ARisAAGi7HAYB7cw_EIEPicnZuk3zOAbNuEP9fKRP4VmYERE37B4nYkLIOfnQYaAis2EALw_wcB



PA6.10

Material_ Eco plastic

<https://www.sweesengrg.com.sg/eco-plastics/>



M75300ZY_ White

Code_ M753

Material_ Ceramic
Finishes_ Matt

<https://www.hafary.com.sg/collection/Tiles/-M75300ZY-3183?image=17923>



Formica Laminate_ Green Slate

Code_ 8793

Material_ Formica
Finishes_ Soft Matt

<https://www.formica.com/en-sg/products/fmashpls1/8793>

11



- **Acacia SupaSleek Wall-Hung Toilet (CL3119B)**

- Design allows for quick and easy exterior cleaning. Easy removal for thorough cleaning.
- Super hydrophilic technology prevents dirt and dark ring stains from sticking to ceramic surface.
- Maximum flushing performance, minimum water usage.
- Water channel design engineered with rimless technology for a powerful performance clean.

6



- **Acacia SupaSleek Vessel 600mm Single-Hole (CCASF420)**

- Modern design with thin edge
- With ceramic drainage included in the set

1



- **Acacia Evolution Towel Bar 600 mm (F51393-)**

3



- **Acacia Evolution Towel Rack (F51395)**

2



- **Acacia Evolution Double Towel Bar (F51394)**

4



- **Easyset Exposed Shower Auto Temperature Mixer With Integrated Rain Shower Kit (FFAS4955)**

- Auto Temperature Mixer (ATM) with German thermostatic cartridge ensuring quality in temperature control for your own comfort and safety
- Starts shower at the push of a button which is preset to your previous shower settings.
- Body of faucet stays cool and prevents scalding shocks.
- Dial adjusts water volume easily and offers daily convenience at the push of a button.
- Safety temperature control up to 49°C, with an auto shut-off function when cold water supply fails.

8



- **Signature Basin Mono With Pop-Up Drain (CFFAS1706)**
 - Adjustable water flow angle for a comfortable, perfect splash-proof experience.
 - Water-saving for ecological and economical sense.
 - Allows easy control with just a simple adjustment of the lever.
 - Minimal lead content provides better health protection compared to standard brass.

5



- **DuoSTiX™ Hygiene Spray_ Full Glossy White (FFASTS28)**
 - A dual cleanse spray that is both gentle on the skin and thorough on bathroom stains. Personal cleansing is all about gentle comfort. But when it comes to tough toilet stains, trust a stronger jet to do an all-out clean.
 - Its stylish yet purposeful design features a removable cap that turns the bidet spray into a jet spray. As a bidet spray, the FlexiFit™ cap can be fitted in either direction so that users can ergonomically access the spray button with either the thumb or index finger. Twist the cap off and it transforms into a focused jet spray for toilet cleaning.
 - Designed with minimal gaps to eliminate dirt trap, the cap can be easily removed for cleaning - enhancing both personal and bathroom hygiene

12



- **Acacia Evolution Toilet Brush (FFAS1386)**

7



- **Acacia Evolution Soap Dish (FFAS1382)**

10



- **Acacia Evolution Tissue Holder (F51387-CHADY55K)**

9



- **Acacia Evolution Towel Ring (F51390-CHADY47K)**

Appendix

Design Story – Limit to 150 words per answer.

- What is the inspiration for your design?

Toilet gets dirty easily due to bacteria and exposure to water and moisture. Thus, cleaning is needed. I had seen how my mother wash the toilet to be clean. It took her quite long. She need to scrub around the toilet bowl placed on the floor, and move the items around on the floor. Therefore, I would like to design the toilet to be washed easier by ensuring all products are off the ground. I also want to bring convenience for different target user. Give them friendly experience of using the toilet. Some part of the design is also based on my own experiences such as using the basin when I'm young. My shirt gets wet easily and hard to reach out for the tap. Now, I need to bend down a lot to wash my face.

- How does the design fulfill the need of the target users?

Different part of the toilet is design specifically. The spray hole allow user to wash their leg as in Singapore, we love to wear slippers or barefoot on ground at home. It's a hassle to cup the water from the sink and let go to wash the feet. Even though there's shower head to use. We tend to choose to cup the water instead. It also makes it easier for the user to wash the toilet bowl.

- How does the design fulfill the design challenge?

The challenge is to design a toilet for a family with elderly and young child (not high to reach out for items). I believe there's still spaces for improvement to cater better for the user. It fulfill by ensuring that it's wheelchair free like ensuring sufficient space to move around. Children is able to access to any items and same goes to the adults_ parents.

- How does the choice of products contribute to the purpose of the design?

The product I chosen satisfy the aesthetic needs of the overall looks and vibe. Including other purpose such as ease of cleaning and use.