

A Home to Love A Space for Everyone Design Entry Template





Design Entry Template Guidelines

You will find the following slides in this Submission Template with specific titles and requirements for your submission as indicated below. Total number of your submission should not exceed 13 slides, beginning with (Slide 1: Project Name) and ends with (Slide 13: Appendix).

SLIDE 1:
Project Name

Input a concept title that reflects your idea.

SLIDE 2:
Design Concept

Describe your concept in a nutshell, keep it within 150 words.

SLIDE 3:
Design: Floorplan and Elevations

Organize your drawings to tell your story.

SLIDES 4-9:
Design: Visuals

Present your concept with your renderings.

- Slide 4: Full Bathroom
- Slide 5: Shower Area
- Slide 6: Toilet Area
- Slide 7: Basin Area
- Slide 8-9: Optional Images

SLIDE 10-11:
Specifications: Colors, Materials and Finishes

SLIDE 12:
American Standard Products Specified

List down the products that are used in your design.

SLIDE 13:
Appendix

Elaborate your design story.

as:da
american standard
design award

asia
pacific
2023

The Oasis Multi-generation Bathroom ASDA23-60004

SLIDE 1



*American
Standard*



Design Concept Summary

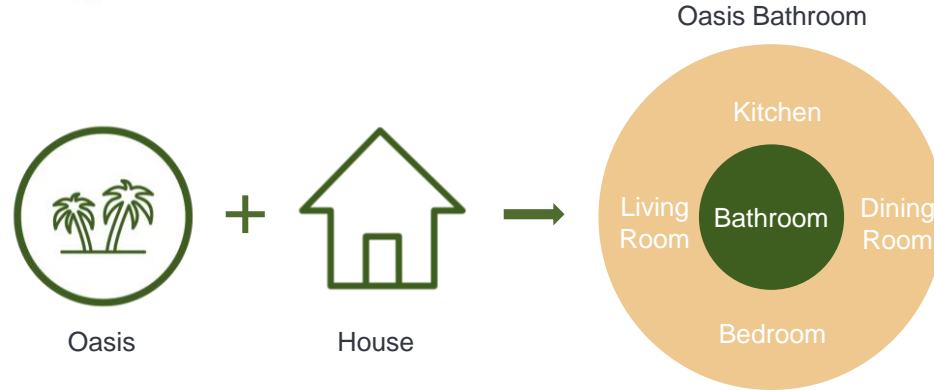

Although the literal meaning of oasis is "a green spot in the desert," it can also be used to describe a peaceful area in our everyday lives, and usually in the bathroom we can find it. When it comes to the multi-generational means involving more than one generation, having more people in the home can make it difficult for everyone to have their own space. This can be very stressful for people who value time alone to unwind after work or are used to having plenty of space for hobbies and projects. Here, all the rooms in the house represent dessert and the bathroom represents a green spot in the desert, where we have our personal space because it provides comfort and relaxation. Therefore, the oasis bathroom will provide a pleasant and cozy space but practical, functional, and as simple as well.

Design: Floor Plan and Elevations

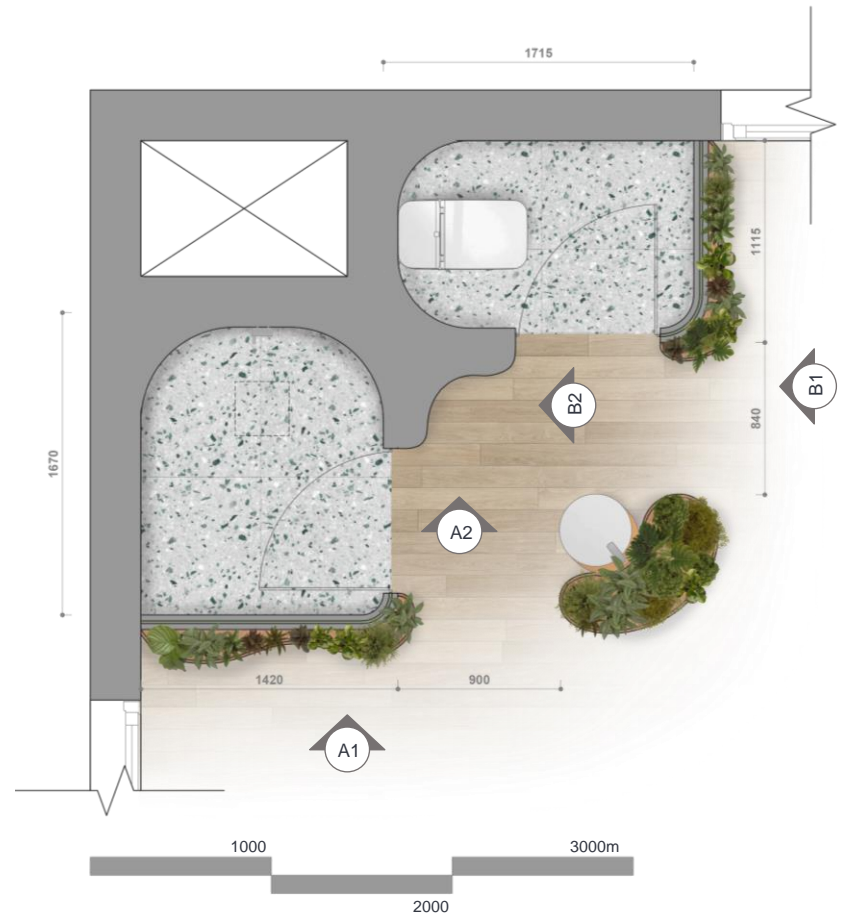

The bathroom provides a separate washbasin, toilet and shower area to ensure privacy, hygiene, and ease of access. An individual option reduces the delay and strain that is expected to ensue in daily life. Therefore, it needs to be accessible and safe for all the members to use the tools and feel secure in the bathroom.

Design:
Floor Plan
and
Elevations



Elevation A1

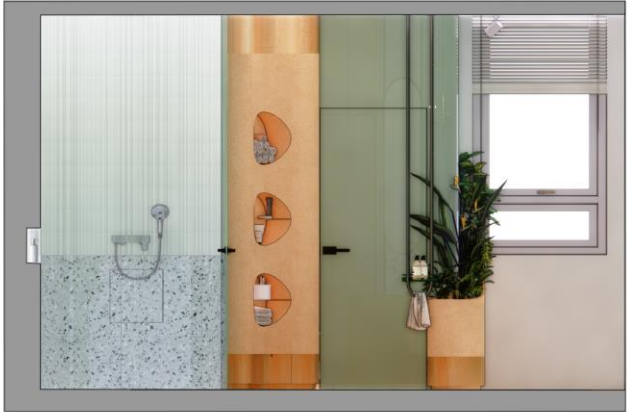

Elevation A2 (showing the shower area)



Elevation B1



Elevation B2 (showing the toilet area)

**Design
Visuals:
Full
Bathroom**



Design Visuals: Shower Area

The shower area is designed as simply as possible so that users can feel calm and comfortable in this space. There is a built-in shelf, and at the same time, it is also built-in handrails for user safety, besides that there is a hidden built-in shower chair that can be used by the elderly or children.

IDS Rain Shower Head 300S (A-952-229) Chrome

Acacia Evolution Exposed Bath & Shower Mixer With Shower Kit

Built-in Shelf

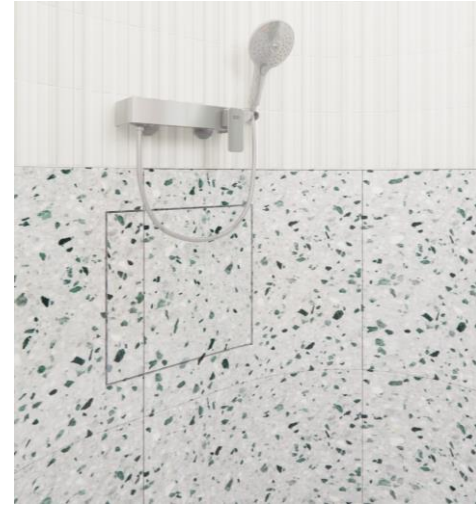

Design Visuals: Toilet Area



Acacia Evolution Tissue Holder

Plat 4/6L Smart Toilet



Built-in cabinet

Focusing on hygiene and cleanliness, the toilet room is separated to prevent contamination from flushing and ensure privacy. Moreover, there is hidden built-in cabinet provides a storage area to store everyone's items.

Design Visuals: Basin Area

The basin area is the focal point here, where it is positioned in an open space, and there are two usable paths which provide easy access for multi-generational users. Besides that, this area is surrounded by greenery that gives a balancing and harmonizing atmosphere.

There is a built-in cabinet customized using copper. This sustainable material is used to highlight the concept of an oasis, which promotes the oasis's development by using environmentally friendly materials. The other reason uses this material is because it antimicrobial, highly durable, and attractive.



Round Copper Cabinet



Signature Extended Basin Mixer With Pop-Up Drain

Acacia Evolution Round Vessel Basin WT



Design Visuals: Optional Images/ Information

when the door is opened (green clear glass)



Closed door but without unlocking it (green clear glass)



Closed door by locked it (change from transparent to opaque green)



For the privacy of the shower and toilet area, smart glass is used. When the door is locked, the glass darkens, coating the lithium ions and electrons transfer from one electrochromic layer to another. By unlocking the door, the polarity is reversed, thus causing the ions and electrons to return to their original layers and their clear state. This product is designed to reduce heat transfer inside and outside a building. Combining this functionality and high insulation property is expected to achieve much higher energy-saving performance. It also creates a healthy environment for the user.

The use of green colour represents nature, which can transcend a sense of calmness and security in space. This colour can provide a moment of calm before you start your day or as you prepare for bedtime.

**Design
Visuals:
Optional
Images/
Information**



Built-in shelf

Built-in handrails

Hidden step stool for kids

Design Visuals: Optional Images/ Information

The grow lights mimic natural light temperatures to help your plants reach their full growth despite being indoors

Automatic watering system is used to allow the user to give each plant the right amount of water, at the required time

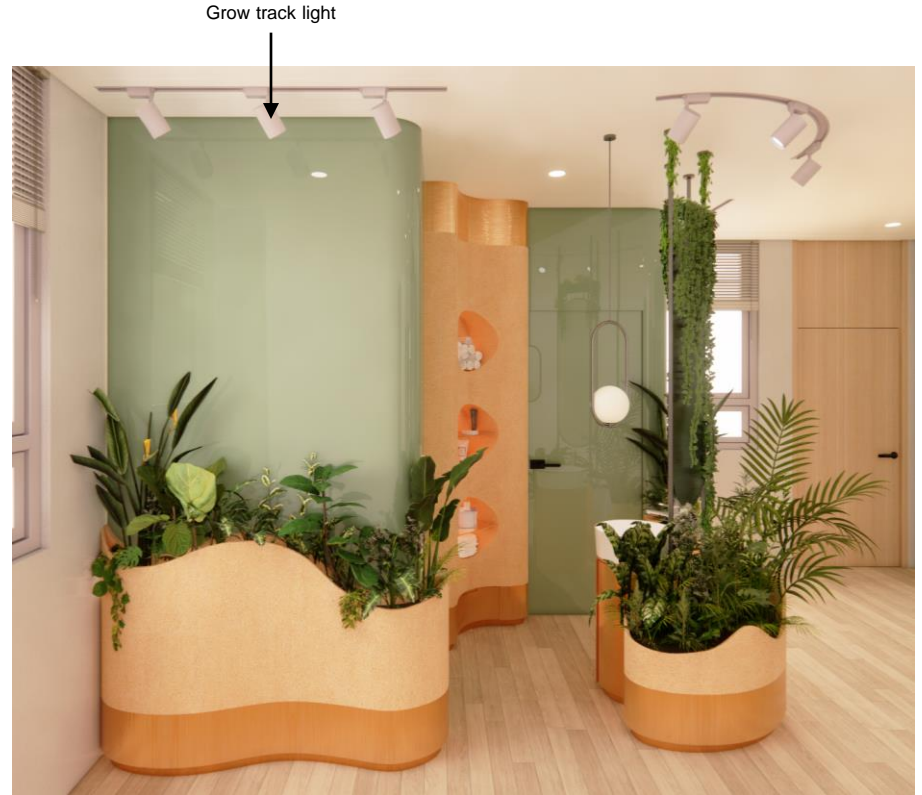

Specifications: Colors, Materials and Finishes

The concept of oasis is closely related to nature; therefore, to protect the ecosystem and preserve natural resources, sustainable materials is used and by being committed to sustainability will reduce your carbon footprint and the amount of toxins released into the environment, making it safe. The use of these materials to make more healthy space for the user.

Wash Basin Area



terracotta

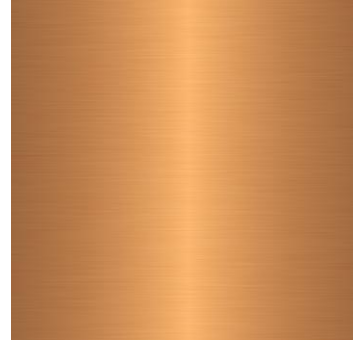

Copper



White Oak Engineered wood

Shower & Toilet Area

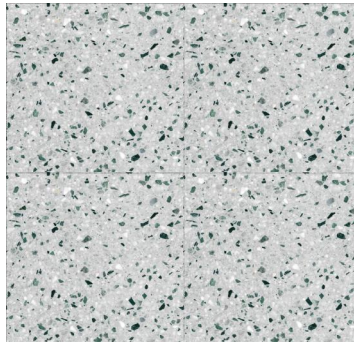

Green Honed terrazzo



White Linear Porcelain Tiles

Specifications: Colors, Materials and Finishes

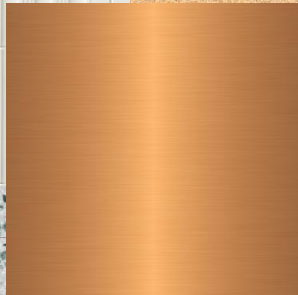

as:da
american
standard
design
award
asia
pacific
2023

**American
Standard
Products
Specified**



IDS Rain Shower Head 300S (A-952-229) Chrome



Signature Extended Basin Mixer With Pop-Up Drain



Acacia Evolution Round Vessel Basin WT



Plat 4/6L Smart Toilet



Acacia Evolution Exposed Bath & Shower Mixer With Shower Kit



Acacia Evolution Tissue Holder



Acacia Evolution Robe Hook

Appendix

Design Story – Limit to 150 words per answer.

- What is the inspiration for your design?

We are now in the phase of the pandemic where life is returning to normal, there is a common concern about lifting lockdowns and how this will cause us to slip back into overwhelmed schedules and burn ourselves out. The OASIS bathroom dissolves boundaries, bringing the outside world indoors and coming home to finding ourselves, refuelling and recovering at one with nature. The OASIS means the green area in an arid region, a desert represents a stressful world, and there is a green area that brings peace. The boundaries between work and relaxation are getting harder to define. It is all too easy now for the stresses of our jobs to creep into our personal lives. The bathroom is the only place to relax without distraction from anyone or anything. While emptying your mind from stressful thoughts, nature brings new inspiration as creative ideas blossom and suppressed dreams surface.

- How does the design fulfill the need of the target users?

The bathroom user is a multigenerational family; therefore, it needs to be accessible and safe for all the members to use the tools and feel secure in the bathroom. The bathroom provides a separate washbasin, toilet and shower area to ensure privacy, hygiene, and ease of access. An individual option reduces the delay and strain that is expected to ensue. Moreover, the use of slip-resistant tile for the floors is an excellent choice to prevent them from slipping and falling. In addition, there are built-in grab rails to avoid slips and falls for the elderly and children.

- How does the design fulfill the design challenge?

When building, modifying or renovating a home to accommodate multigenerational living, bathroom design and fittings play a massive role in creating livable spaces for both young and old. In this design, the bathroom will connect all the family members to nature; the use of nature can be demonstrated to anyone. Nature is essential for many and vital in keeping us emotionally, psychologically and physically healthy. A strong connection with nature means feeling a close relationship or an emotional attachment to our natural surroundings. Moreover, The design is to optimize usable area by separating each function of the washbasin, toilet, and bathroom, making it all possible to use simultaneously and easily clean.

- How does the choice of products contribute to the purpose of the design?

With the concept related to nature, where the material used is sustainable. The choice of products almost all fulfil the purpose of simple design, keeping a space simple and uncluttered and accentuating attractive features. The product also offers durability, ease of use, and assurance for the user. Most importantly, it did not interrupt the space to create a soothing and inviting space with a timeless aesthetic.

as:da

american
standard
design
award

asia
pacific
2023

**Your idea can
shape how we
create homes
to love**

*American
Standard*

