

as:da

american
standard
design
award

asia
pacific
2024

Nurturing Nature Harmony in our Common Home

ASDA24-53913

American Standard



Design Concept Summary

Home away from Home. With the world full of diverse cultures and environments, it was almost impossible to find a universal theme that would characterize all forms of home in different places and cultures around the world. However, this is untrue, we do have one common home—*Mother Earth*. This concept aims to harmonize living with nature, avoiding reliance on artificial light and ventilation. It is not designed for simple existence; it actively interacts with the surroundings, reflecting its spirit in color and mood. Designed for all ages, genders, and disabilities, this bathroom prioritizes sanitation, privacy, and accessibility, for nature is the home of everyone.

Nature is essential for a peaceful bathroom experience. This space celebrates diversity and transforms into a shared home, resonating with the nurturing essence everyone seeks in their home away from home; for **nurture is nature**.



Design: Floor Plan and Elevatio

- The space is segmented into two zones: **wet and dry.**
- Designed for **simultaneous use** by multiple users, with partitions providing privacy.
- **Curved corners** facilitate easier cleaning and prevent dirt buildup.
- Large floor tiles ensure easy maintenance.
- Utilization of **anti-skid and grooved tiles** enhances safety in the space.

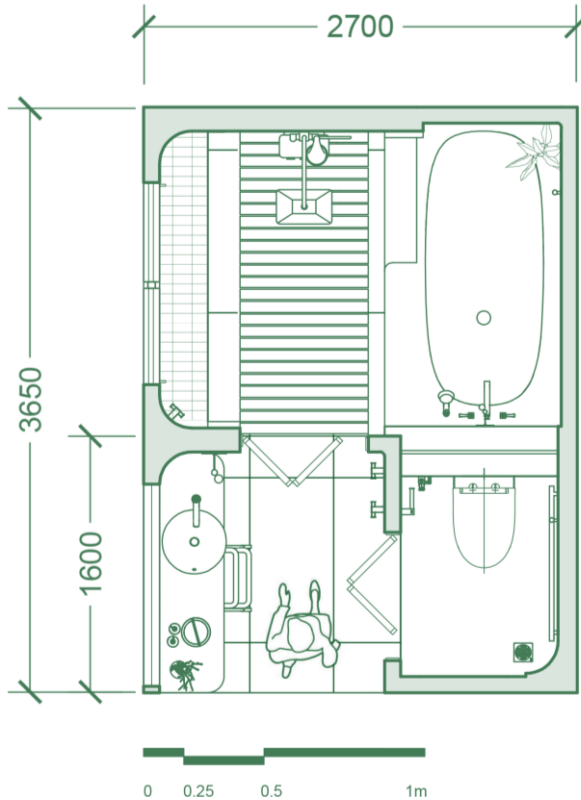

FLOOR PLAN



SECTION 01

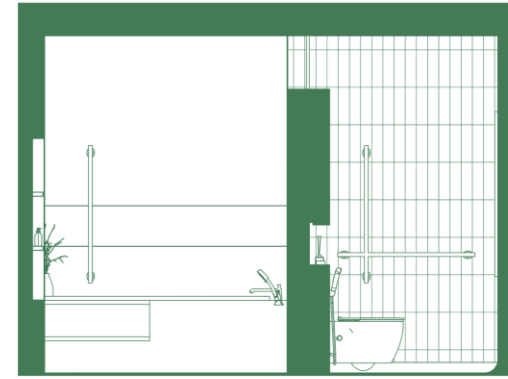

SECTION 02

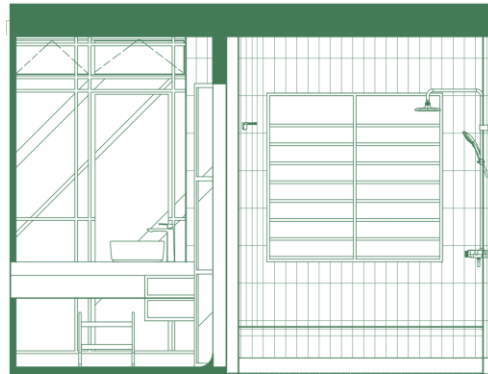

SECTION 03

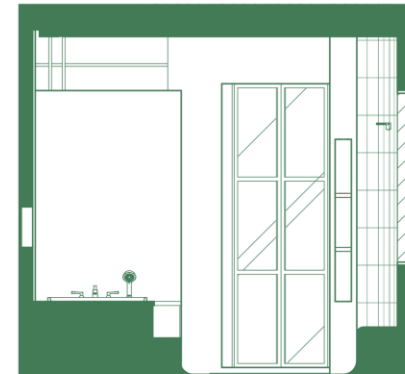

SECTION 04

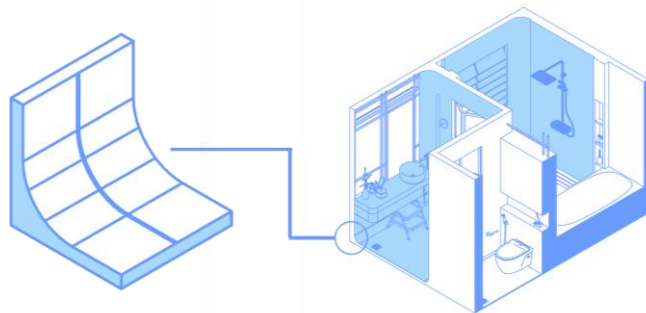

1

Curved Corners and Edges

Hotel and resort owners often struggle with time-consuming bathroom maintenance. Cleaning staff spend a significant portion of their day managing this task. To address this issue, I considered implementing a technology commonly used in kitchens, which proves equally advantageous for bathrooms. Introducing curved corners and edges can deter rats from navigating through wall corners, as rats tend to favor straight angles. Moreover, the curved design minimizes the accumulation of dirt and prevents corners from darkening.

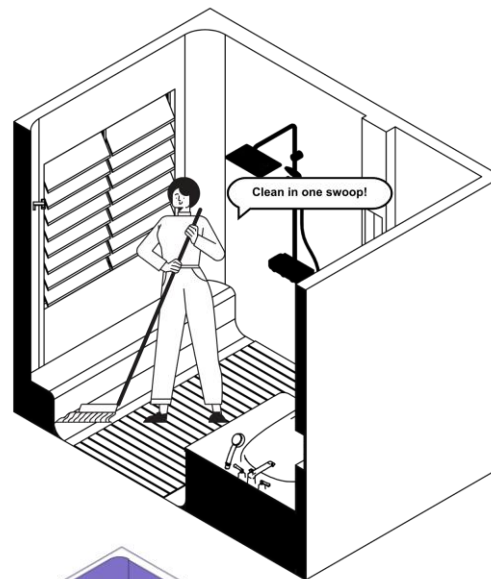

2

Passive Design

I aim to maximize bathroom freshness and energy efficiency with operable awning and jalousie windows, allowing abundant natural light to brighten the space and reduce the need for artificial lighting. Light-colored floors further harness sunlight to create a well-lit environment, contributing to both **energy savings** and **passive bacteria elimination**.

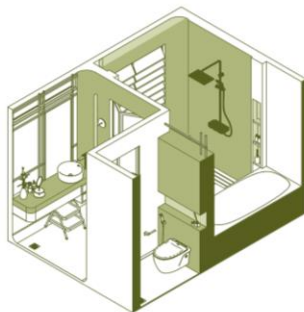

3

Color Therapy

To create a soothing atmosphere, I used colors based on color therapy. According to studies, earth tones evoke nature, with **green having a calming effect**. Soft greens can give a spa-like feel, while soft white suggests cleanliness and relief. Adjustable **Chroma-therapy lights** let users control brightness and mood for maximum comfort.



4

Simultaneous Use + Privacy

This bathroom is made for multiple people to use at once. Frosted glass doors are used for privacy, so everyone can use the bathroom at the same time without waiting for others to finish.

Design Visuals: Full Bathroom

Curves are present in almost every edge and corner of this bathroom design. Throughout history, curves have been a symbol of beauty. Curves are frequently associated with harmony and balance, as **curves are prevalent in nature**, and many natural forms exhibit curved shapes and patterns.

The incorporation of curves in the design provides users with a sense of flow and harmony. Beyond aesthetic appeal, these curves were deliberately chosen for practical reasons, **offering ease of cleaning and maintenance for hotel owners.**



**Design
Visuals:**
Full
Bathroom



Design Visuals: Shower Area

- Multiple seating areas provide guests/couples a place to rest or chat before, during, or after showering, with the option to enjoy sunlight or a breeze by the window, inspired by saunas.
- The bathtub also serves as a comfortable seating option, catering to users with difficulties getting in, such as elders or kids.

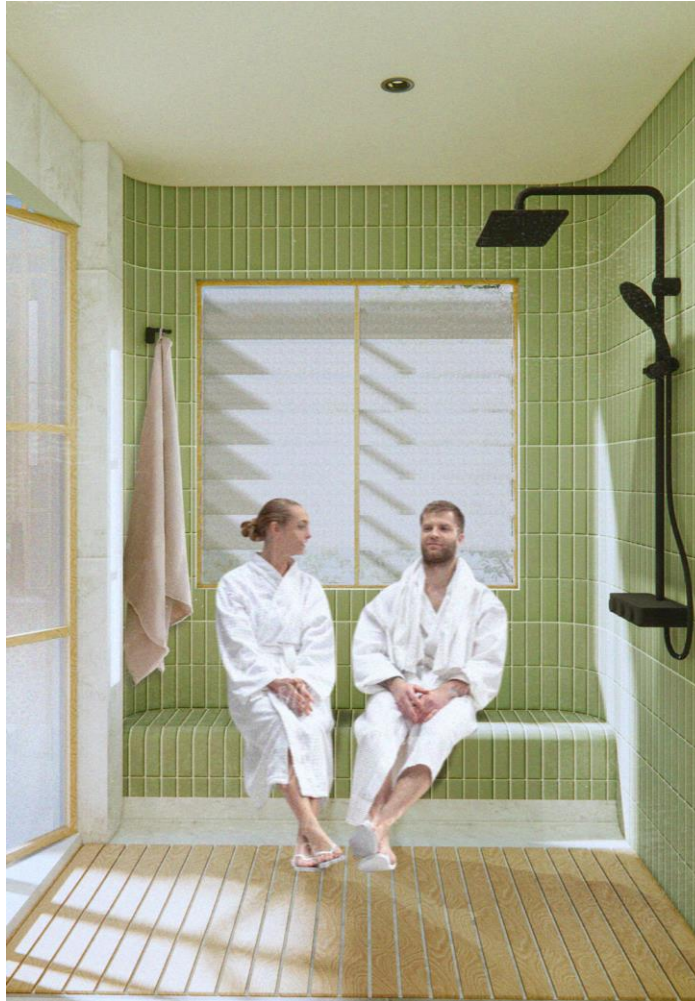

Design
Visuals:
Toilet
Area

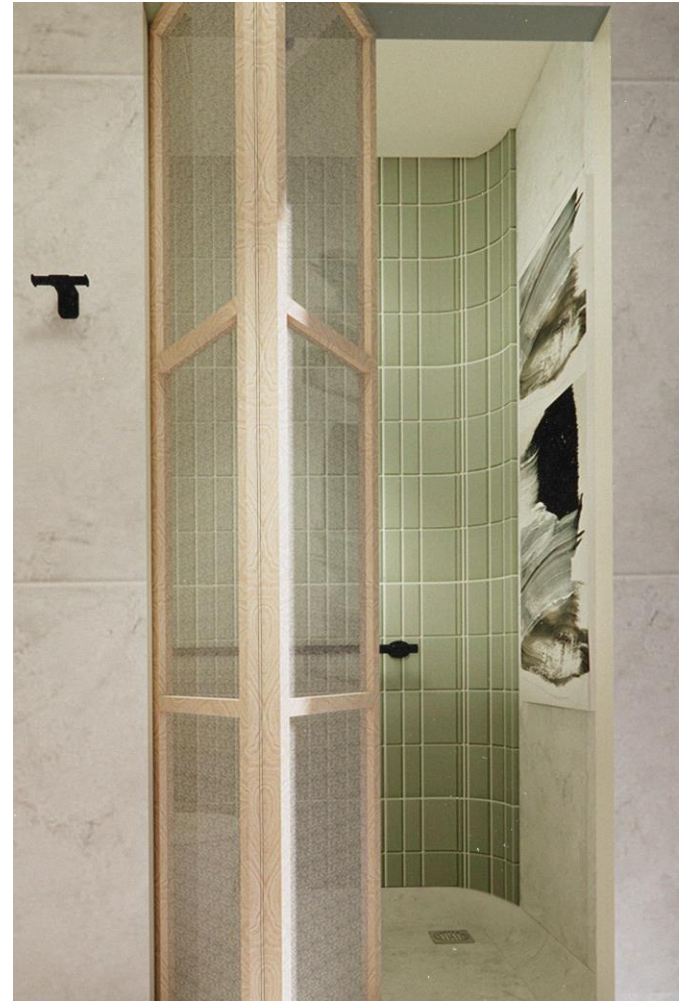
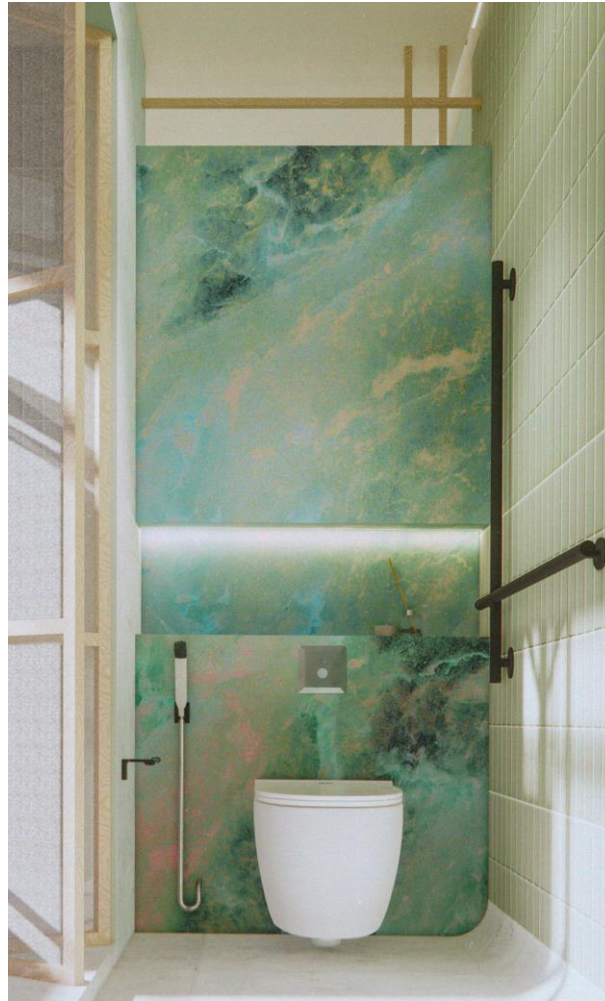

Design Visuals: Basin Area

- Large windows provide ample natural light, ideal for vanity activities like makeup application, outfit checking, skincare, and teeth brushing.
- Enjoy outside views through the windows or use the Smart Privacy Window for added privacy.
- The presence of a full-length mirror enhances the perception of spaciousness in the bathroom.



Mini Washing Machine

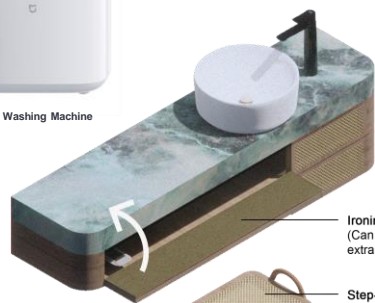

Ironing Board
(Can also be used as an extra vanity space)

Step-Stool
(Can also be used as additional storage)

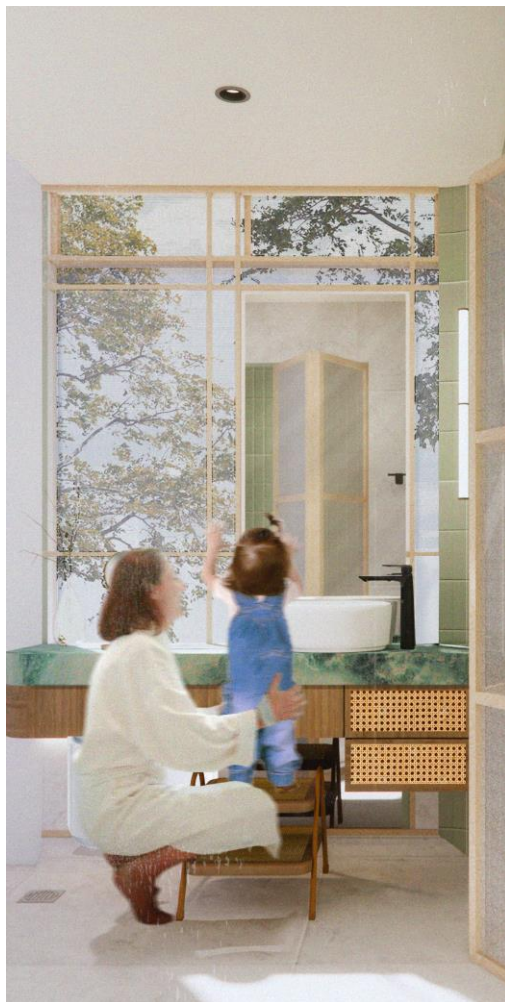

**Design
Visuals:**
Optional
Images/
Information

Nurturing Nature
Concept Collage

This hospitality bathroom borrowed philosophy from **Zen**. In Zen philosophy, there's an emphasis on **being present in the moment** and **finding harmony with the natural world**.



Specifications: Colors, Materials and Finishes

White Moisture Resistant Gypsum
(Ceiling)

Privacy Smart Glass/Frosted Glass
(Privacy Smart Glass for Large Fixed Windows; Normal Frosted Glass for Openable Windows + Partitions)

Anti Slip Porcelain Light Grey Matt Tiles
(Floor and Walls)

Matte Black Steel
(Fixtures)

Aluminum Wooden Powder Coat /Wood Ceramic
((Window and Partition Framing, Decorative Panel, etc.)

Light Sage Green Tiles
(Walls)



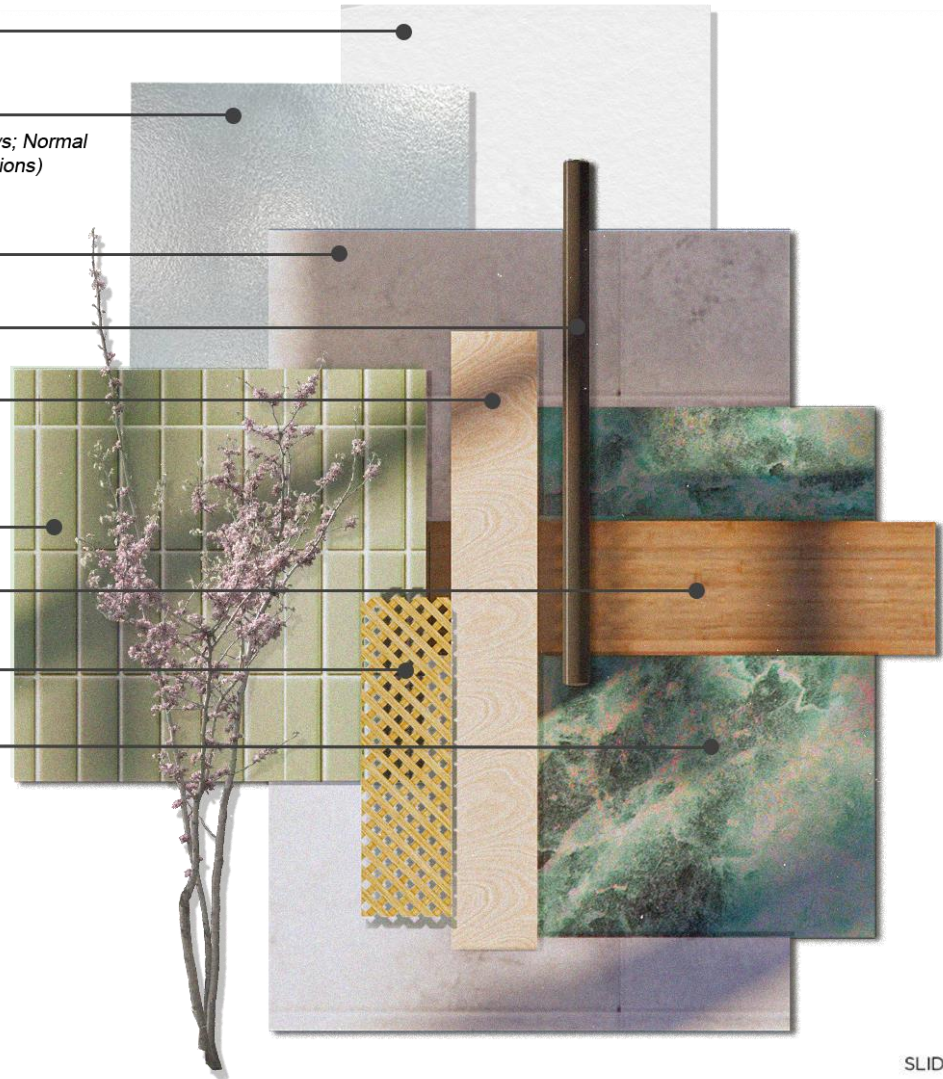

PVC Wood
(Cabinet)

Solihiya Rattan Weave
(Vanity, Stool, etc.)







Green Marbled Quartzite
(Vanity Top, Walls, etc.)



American Standard Products Specified

	Product Name	Product Image	Reason for Selection
1	Acacia SupaSleek CL31197 Wall Hung Toilet		Wall-hung toilets are more hygienic due to their floor-free design, minimizing dirt buildup. Ideal for hotels/resorts with frequent bathroom cleaning, they are aqua ceramic which further promotes cleanliness. The water-saving feature aligns with sustainable bathroom design.
2	DuoStix Hygiene Spray Chrome/Matte Black		This product quickly became my favorite due to its comprehensive features that perfectly align with my design needs. I particularly like its easy clean feature and its multifunction feature for personal and bathroom cleaning. It's a win-win for both guests and owners!
3	Acacia Evolution Round Vessel Basin WT		Given the prominence of curves in the nature concept, I opted for a basin with graceful curves. The rounded shape symbolizes the sun or moon within this design, imparting a sleek, classy look that is also easy to clean.
4	Signature Extended Basin Mixer with Pop Up Drain		I used the Signature because of its timeless and classy look. It also has water-saving features that align with my design objective.
5	KASTELLO Deck Mount Bath & Shower Mixer with Shower Kit		The shower mixer with shower kit, has ComfortMove , TwistFree , and ergonomic features . This aligns seamlessly with my design focus on accessibility, providing a user-friendly experience that caters to a diverse group of people.

American Standard Products Specified

	Product Name	Product Image	Reason for Selection
6	EasySET Exposed Shower Auto Temperature Mixer with Integrated Rain shower Kit		Another top pick for me! Supporting diversity in my design, this shower kit simplifies things by automatically adjusting water temperature—great for those sensitive to cold water, especially individuals with health concerns. The two different showerheads accommodate guests with varied preferences. It's easy to use, with simple controls, and includes a Thermosafe feature to ensure user safety in case the cold water supply runs out.
7	Acacia Evolution Robe Hook		It has a modern and classy appearance that complements the overall design style of the space.
8	Floor Drain 3.5 " Square (Stainless)		It's easy to clean and it is easy to install. It also has curves!
9	Acacia Evolution Paper Holder		Matte Black Color Fitting; It has a modern and simple design
10	Zenistone Floor-Standing Tub (Round)		With a contemporary appearance, its curves enhance the design concept, adding a timeless and classy touch.
11	Senseflow Concealed Sensor Toilet Flush Valve (DC) with Manual Override		Easy to clean + Water-saving features

Appendix

Design Story – Limit to 150 words per answer.

- What is the inspiration for your design?

Drawing inspiration from personal experiences in hospitality bathrooms, my aim was to address common discomforts. Many aesthetically pleasing bathrooms I encountered felt dark, cold, and messy. In creating this design, I aim to create a universally appealing space, also focusing on long-term low maintenance.

Recognizing nature as a universally comforting environment, the result is a simple, minimalistic bathroom that harmoniously incorporates natural elements and function. The design caters to individuals of all ages, genders, and disabilities, ensuring a welcoming and inclusive experience for everyone.

- How does the design fulfill the need of the target users?

Ensuring a nurturing experience, the bathroom design prioritizes unconscious fulfillment of guests' needs. Emphasizing accessibility, safety, and privacy; spaces are divided, but to avoid overcrowding, an open-plan layout for the shower area was maintained. Customized fixtures, including grab handles and anti-slip tiles, enhance safety and comfort. Even the colors contribute to the well-being of the users.

Beyond guest satisfaction, the design considers the long-term viability for the hospitality business, focusing on cleanliness, sustainability and maintenance to serve diverse guests over decades. This approach ensures a welcoming environment where both guests and owners benefit from an enduring bathroom experience.

- How does the design fulfill the design challenge?

Meeting the design challenge involves focusing on the essentials: nature and humanity. By prioritizing these aspects, functionality and aesthetics naturally fall into place. The aim is to transform the bathroom into more than a mere functional area, encouraging users to perceive it as a living space—a place to interact with nature, connect with loved ones, and find solace.

This design integrates science and fundamental design principles, creating a bathroom that serves as a safe haven, a home. Its simple yet timeless aesthetic ensures universal comfort, complemented by a strong focus on functionality, safety, and an enriching overall experience.

- How does the choice of products contribute to the purpose of the design?

Given the nature-inspired concept, sustainability is inevitable in the design. It's beneficial that American Standard consistently prioritizes sustainability in all their products, with their water saving features, which lessened the additional research I needed to do. It's also a plus that the products have a simple and classic aesthetic that can fit to any type of interior style.

Maintenance was an integral part of the design, and American Standard products have features that make it convenient and easy to clean, most products also having a self-cleaning feature. Guest comfort is prioritized with products like the EasySet Exposed Auto Temperature Mixer, which automatically adjusts water temperature—beneficial for those sensitive to cold water, particularly individuals with health concerns. All of these combined result in a harmonious environment for both bathroom guests and the owners.