

Purposeful Design Transforming the Way We Live

Design Entry Template





Design Entry Template Guidelines

You will find the following slides in this Submission Template with specific titles and requirements for your submission as indicated below. Total number of your submission should not exceed 12 slides, beginning with (Slide 1: Project Name) and ends with (Slide 12: AS Products Specified).

SLIDE 1: **Project Name**

Input a concept title that reflects your idea.

SLIDE 2: **Design Concept**

Describe your concept in a nutshell, keep it within 150 words.
NOTE: You will elaborate more in the Design Story Document.

SLIDE 3: **Design: Floorplan and Elevations**

Organize your drawings to tell your story.

SLIDES 4-9: **Design: Visuals**

Present your concept with your renderings.

- Slide 4: Full Bathroom
- Slide 5: Shower Area
- Slide 6: Toilet Area
- Slide 7: Basin Area
- Slide 8-9: Optional Images

SLIDE 10- 11: **Specifications: Colors, Materials and Finishes**

SLIDE 12: **American Standard Products Specified**

List down the products that are used in your design.

LAND

**Participant ID:
ASDA22-90088**





Design Concept

By using the raw materials, helping human to connect with the nature, embrace the nature and be surrounded by nature. In contrast with the raw materials, the refined products of American Standard bring a sense of attraction to the space.

Design: Floor Plan and Elevations

The sinks are arranged close to the door to help keeping the hygiene in the pandemic, the bathing area is near the window with the view of the outside, the toilet is placed inside bringing a private and comfort feelings for the users.

Beside allowing for illumination from the front door, the bathroom also uses small openings in the walls and ceiling to create streaks of sunlight for the space.

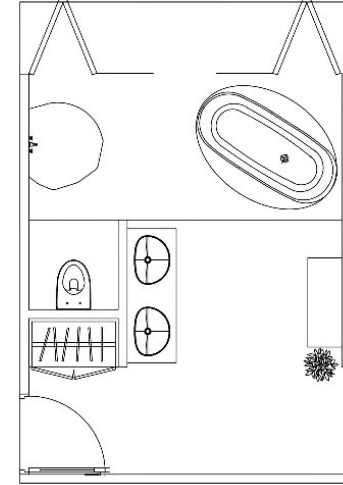

Design Visuals: Full Bathroom

Using the rustic materials as the base, combining with the shiny bathroom products to create a nice and subtle contrast.



Design Visuals: Shower Area

The bathtub is placed near the big door will allow the user to relax and enjoy the scenery outside more easier.



Design Visuals: Shower Area

The shower stall is arranged near the bathtub.



Design Visuals: Toilet Area

The toilet installed in the private space will make the users more comfortable to use.

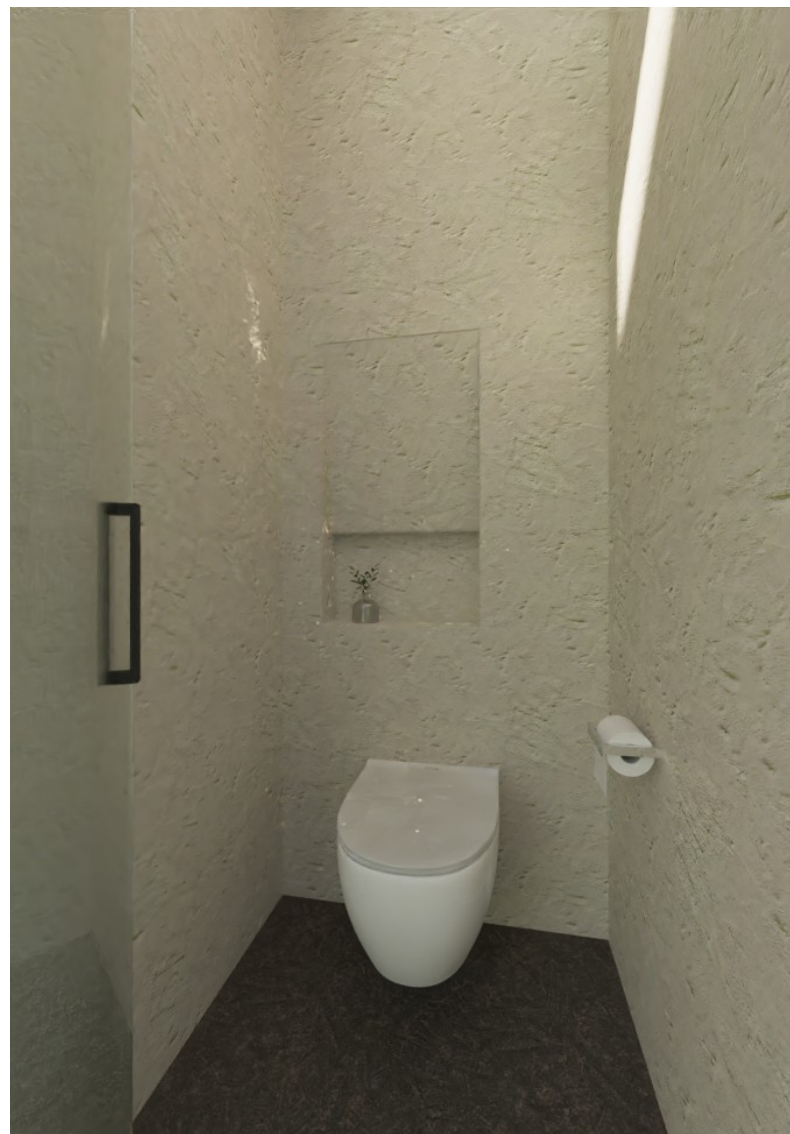

Design Visuals: Basin Area

Two-people sink, arranged
near the exit that will help
keeping the hygiene.



Specifications: Colors, Materials and Finishes

The design uses rustic materials with neutral colors to bring a feelings of relaxation and gentleness, as well as accentuate the refine of the bathroom products.



American Standard Products Specified

The chosen products have delicate curves together with excellent functions and shiny materials that will contribute to the present the idea of the design.



WP-F633



WF-0616



3119E-WT



**May Your Idea
Make a Difference
Good luck!**

