

SCI FI BATHROOM

ASDA22 - 30107





Design Concept

FLUID GEOMETRY + TECTONIC GEOMETRY

I HAVE CREATED A DESIGN BASED ON MY RECENT EXPERIENCE, THAT WE ARE FORCED TO EXPERIENCE THE SIMILAR SPACE IN TERMS OF THE FORM. THE CHANGE OF EXPERIENCE IS ALWAYS A NEED FOR AN INDIVIDUAL. IN TERMS OF MY DESIGN, I GOT INSPIRED FROM NATURE AND THE MOVIE BLADE RUNNER. THE BLENDING OF STRAIGHT LINES FROM TECTONIC GEOMETRIES AND THE FLUID CURVES FROM NATURAL ELEMENTS CREATES A UNIQUE EXPERIENCE FOR THE USERS.

Design:
Floor Plan
and
Elevations



PLAN



SECTION 1



SECTION 2

**Design
Visuals:
Full
Bathroom**

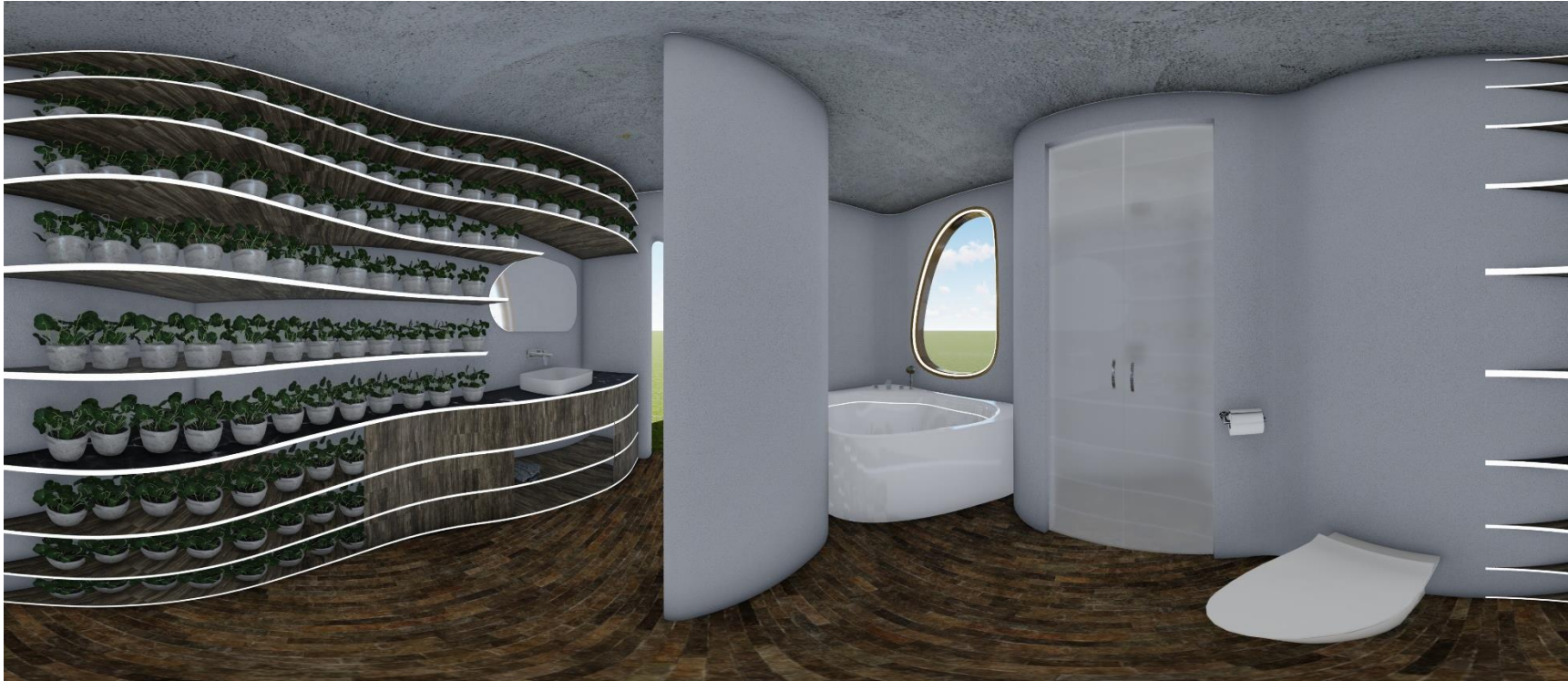

Design Visuals: Shower Area



This image shows the top view of the shower area and outer separation of the areas

Design Visuals: Toilet Area



These visuals show the pictures of the wc location and user's experience when he uses the wc respectively



Design Visuals: Basin Area



Use this text box for description, if required.

Use Space on the right to show basin area visuals.

Specifications: Colors, Materials and Finishes



FLOOR TILES



SHELF WOOD TEXTURE

**American
Standard
Products
Specified**



Bath Spout



Wall Mount Mixer
with Pop Up Drain



Deck Mount Bath & Shower Mixer
with Shower Kit



Back-To-Wall



Vessel 550mm
L380 x W550 x H110mm



Concealed Bath and Shower Mixer

as:da
american
standard
design
award
asia
pacific
2022